

| | | | | | |
|------------------------------------|--|-----------------------|--|---|--|
| Without vertical jackscrews | | 125 HP 04 Poles 60 Hz | | A | |
| DE roller bearing | | | | | |
| Grease outlet according to IEEE841 | | | | | |
| Shaft locking device | | | | | |
| Color RAL 5009 | | | | | |
| Painting plan 222E | | | | | |
| Mounting NEMA F-1 | | | | | |
| Mounting B3R(D) | | | | | |

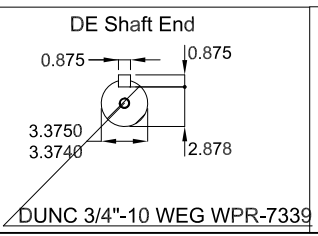

| | | | | | | | | | | | | | | | | | |
|-----------|--|------------|--|--|--|------------|--|----------|--|----------|--|----------|--|------|--|-----|--|
| ECM | | LOC | | SUMMARY OF MODIFICATIONS | | HYBRISUSER | | EXECUTED | | CHECKED | | RELEASED | | DATE | | VER | |
| EXECUTED | | HYBRISUSER | | THREE PH. MOTOR IEEE 841 W22 NEMA PREM. EFF. | | EXECUTED | | CHECKED | | RELEASED | | DATE | | VER | | 00 | |
| CHECKED | | | | FRAME 444/5T IP56 TEFC | | EXECUTED | | CHECKED | | RELEASED | | DATE | | VER | | 00 | |
| RELEASED | | | | | | EXECUTED | | CHECKED | | RELEASED | | DATE | | VER | | 00 | |
| REL. DATE | | | | | | EXECUTED | | CHECKED | | RELEASED | | DATE | | VER | | 00 | |

PREVIEW
WDD 00
SHEET /