

- Without vertical jackscrews
- DE roller bearing
- Grease outlet according to IEEEE841
- Shaft locking device
- NDE endshield with electrically insulated bearing hub
- Color RAL 5009
- Painting plan 222E
- Mounting NEMA F-1
- Mounting B3R(D)

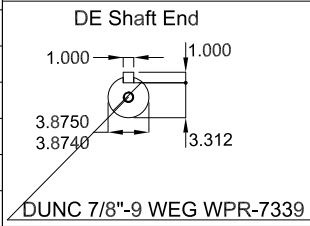

350 HP 06 Poles 60 Hz A

ECM			LOC			SUMMARY OF MODIFICATIONS			HYBRISUSER		00			
EXECUTED			HYBRISUSER			THREE PH. MOTOR IEEE 841 W22 NEMA PREM. EFF. FRAME 586/7T IP55 TEFC			PREVIEW					
CHECKED									EXECUTED	CHECKED		RELEASED	DATE	VER
RELEASED														
REL. DATE														

Dimensions in inches

A3