

A

B

C

D

E

- Without vertical jackscrews
- DE roller bearing
- Shaft locking device
- Shaft material - AISI/SAE 4140
- Color RAL 5009
- Painting plan 203A
- Mounting B3L(E)

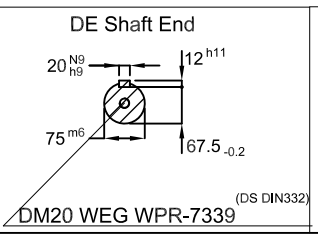

100 HP 04 Poles 60 Hz						A			
ECM	LOC	SUMMARY OF MODIFICATIONS			HYBRISUSER	00			
EXECUTED	HYBRISUSER		THREE PH. MOTOR W22 IE3	EXECUTED	CHECKED	RELEASED	DATE	VER	
CHECKED			FRAME 280S/M IP55 TEFC						
RELEASED									
REL. DATE									
				PREVIEW					
				WDD 00					
				SHEET /					