

| | | | | | | |
|------------------------------------|--|--|--|----------------------|--|---|
| Without vertical jackscrews | | | | 60 HP 04 Poles 60 Hz | | A |
| Stainless Steel Grease fitting | | | | | | |
| Sealing - Taconite labyrinth | | | | | | |
| Grease outlet according to IEEE841 | | | | | | |
| Color RAL 5009 | | | | | | |
| Painting plan 222E | | | | | | |
| Mounting B34R(D) | | | | | | |

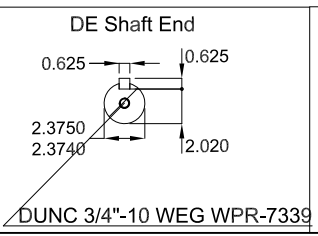

| | | | | | | | | | |
|-----------|------------|-----|--|--|---------|------------|------|-----|--|
| ECM | | LOC | | SUMMARY OF MODIFICATIONS | | HYBRISUSER | | 00 | |
| EXECUTED | HYBRISUSER | | | EXECUTED | CHECKED | RELEASED | DATE | VER | |
| CHECKED | | | | THREE PH. MOTOR IEEE 841 W22 NEMA PREM. EFF. | | PREVIEW | | | |
| RELEASED | | | | FRAME 364/5TC IP55 TEFC | | WDD 00 | | | |
| REL. DATE | | | | | | SHEET / | | | |

Dimensions in inches

A3