

DATA SHEET

Three Phase Induction Motor - Squirrel Cage



Customer :

Product line : W22 NEMA Premium Efficiency Three-Phase Product code : 12717203

Frame	: 182/4TC	Locked rotor time	: 41s (cold) 23s (hot)
Output	: 3 HP (2.2 kW)	Temperature rise	: 80 K
Poles	: 4	Duty cycle	: Cont.(S1)
Frequency	: 60 Hz	Ambient temperature	: -20°C to +40°C
Rated voltage	: 575 V	Altitude	: 1000 m.a.s.l.
Rated current	: 3.21 A	Protection degree	: IP55
L. R. Amperes	: 26.3 A	Cooling method	: IC411 - TEFC
LRC	: 8.2x(Code K)	Mounting	: F-1
No load current	: 1.60 A	Rotation ¹	: Both (CW and CCW)
Rated speed	: 1765 rpm	Noise level ²	: 56.0 dB(A)
Slip	: 1.94 %	Starting method	: Direct On Line
Rated torque	: 1.23 kgfm	Approx. weight ³	: 45.1 kg
Locked rotor torque	: 220 %		
Breakdown torque	: 320 %		
Insulation class	: F		
Service factor	: 1.25		
Moment of inertia (J)	: 0.0143 kgm ²		
Design	: B		

Output	50%	75%	100%	Foundation loads	
Efficiency (%)	87.5	88.5	89.5	Max. traction	: 60 kgf
Power Factor	0.58	0.69	0.77	Max. compression	: 105 kgf

Losses at normative operating points (speed;torque), in percentage of rated output power

P1 (0,9;1,0)	P2 (0,5;1,0)	P3 (0,25;1,0)	P4 (0,9;0,5)	P5 (0,5;0,5)	P6 (0,5;0,25)	P7 (0,25;0,25)
12.7	11.2	10.8	6.7	5.0	3.7	2.8

		<u>Drive end</u>	<u>Non drive end</u>
Bearing type	:	6207 ZZ	6206 ZZ
Sealing	:	V'Ring	V'Ring
Lubrication interval	:	-	-
Lubricant amount	:	-	-
Lubricant type	:	00088	

Notes

This revision replaces and cancel the previous one, which must be eliminated.

- (1) Looking the motor from the shaft end.
- (2) Measured at 1m and with tolerance of +3dB(A).
- (3) Approximate weight subject to changes after manufacturing process.
- (4) At 100% of full load.

These are average values based on tests with sinusoidal power supply, subject to the tolerances stipulated in NEMA MG-1.

Rev.	Changes Summary	Performed	Checked	Date
Performed by		Page Revision 1 / 2		
Checked by				
Date	13/11/2025			

LOAD PERFORMANCE CURVE

Three Phase Induction Motor - Squirrel Cage



Customer :

Product line : W22 NEMA Premium Efficiency
Three-Phase

Product code : 12717203

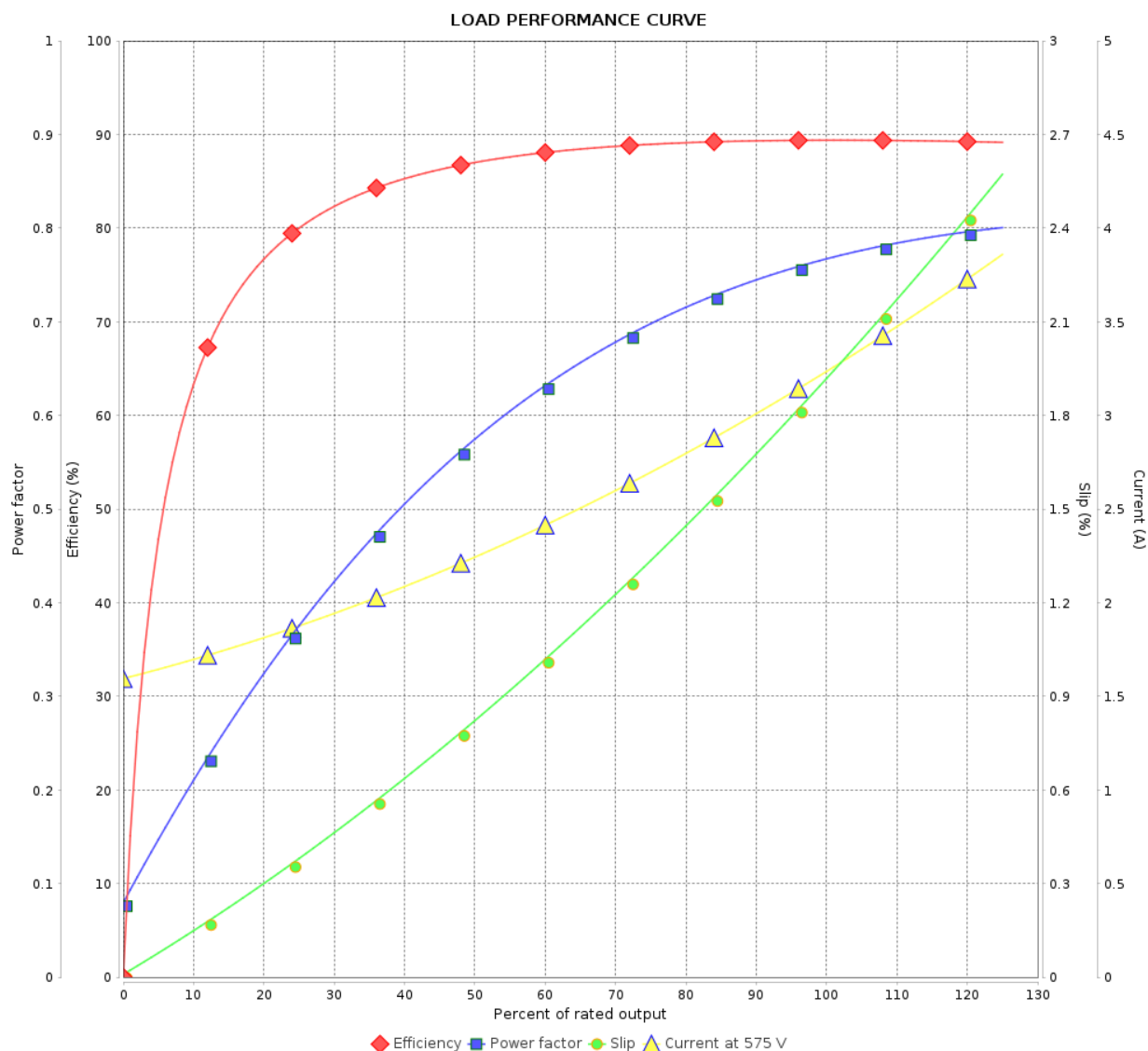

Performance : 575 V 60 Hz 4P

Rated current : 3.21 A
LRC : 8.2
Rated torque : 1.23 kgfm
Locked rotor torque : 220 %
Breakdown torque : 320 %
Rated speed : 1765 rpm

Moment of inertia (J) : 0.0143 kgm²
Duty cycle : Cont.(S1)
Insulation class : F
Service factor : 1.25
Temperature rise : 80 K
Design : B

Rev.	Changes Summary		Performed	Checked	Date
Performed by				Page 2 / 2	Revision
Checked by					
Date	13/11/2025				

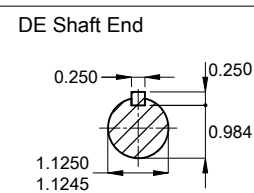
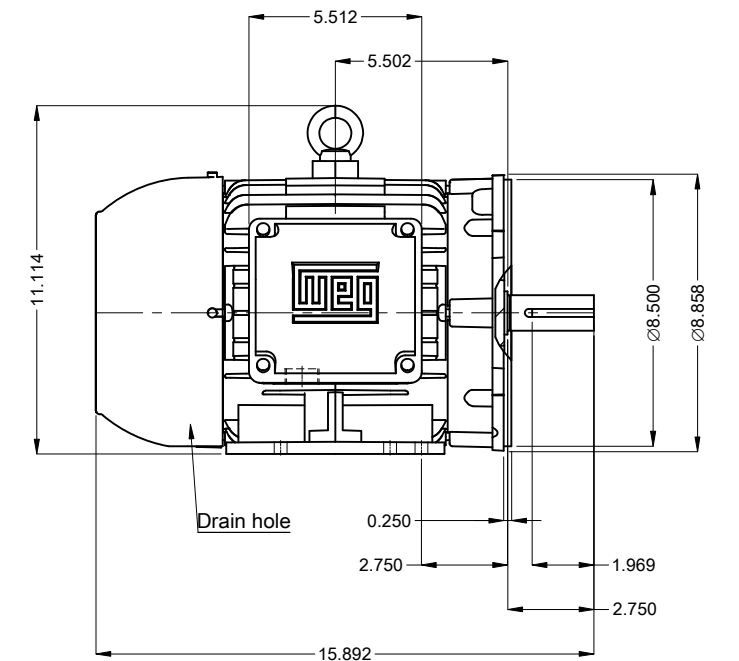
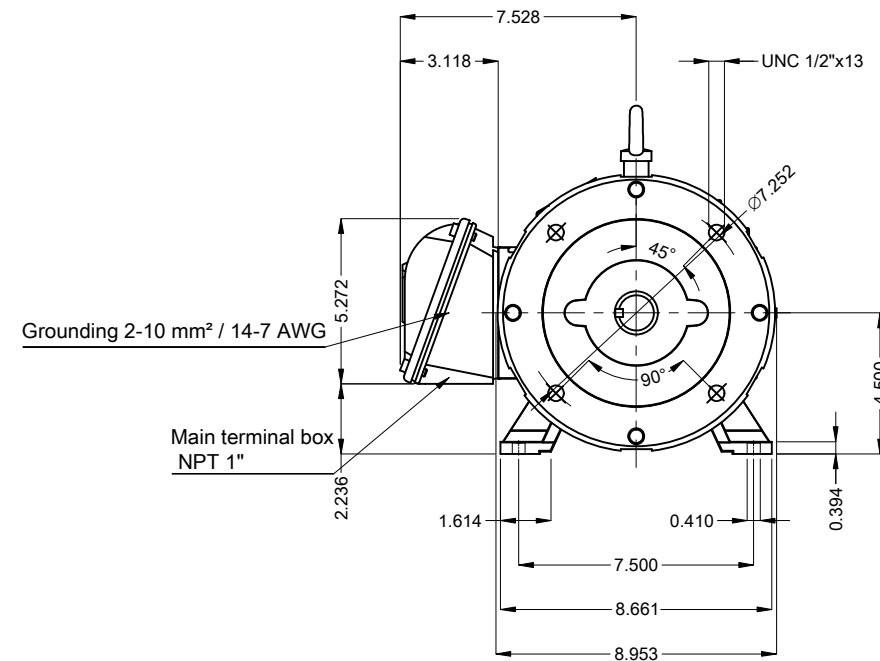
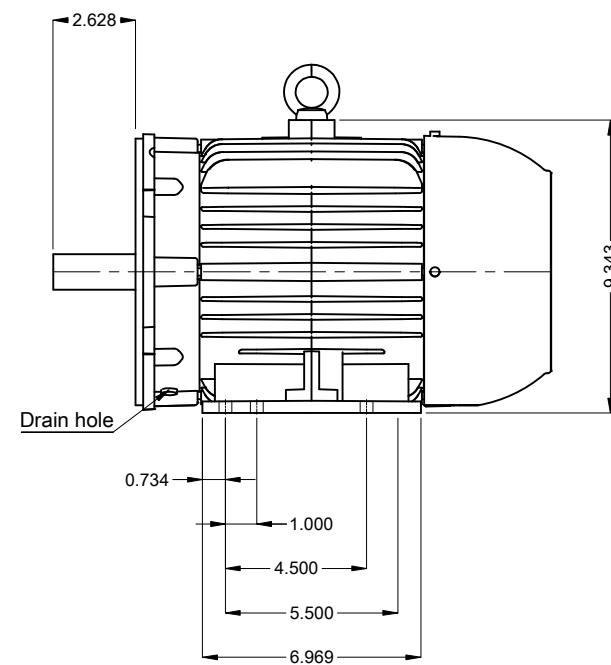

Color RAL 5009
Painting plan 207A
Mounting NEMA F-1
Mounting B34D

3 HP	04 Poles	60 Hz
------	----------	-------

Scale 1 : 6

ECM

LOC

SUMMARY OF MODIFICATIONS

HYBRISUSER

EXECUTED

CHECKED

RELEASED

DATE	VE
------	----

A	
---	--

PREVIEW

WDD

00

SHEET	1 / 1
-------	-------

