

# DATA SHEET



## Three Phase Induction Motor - Squirrel Cage

Customer :

Product line : W22 Tru-Metric IE3 Three-Phase Product code : 11989184

Frame	: 180M	Locked rotor time	: 19s (cold) 11s (hot)
Output	: 30 HP (22 kW)	Temperature rise	: 80 K
Poles	: 2	Duty cycle	: S1
Frequency	: 60 Hz	Ambient temperature	: -20°C to +40°C
Rated voltage	: 575 V	Altitude	: 1000 m.a.s.l.
Rated current	: 28.2 A	Protection degree	: IP55
L. R. Amperes	: 273 A	Cooling method	: IC411 - TEFC
LRC	: 9.7	Mounting	: B35L(E)
No load current	: 11.2 A	Rotation <sup>1</sup>	: Both (CW and CCW)
Rated speed	: 3565 rpm	Noise level <sup>2</sup>	: 72.0 dB(A)
Slip	: 0.97 %	Starting method	: Direct On Line
Rated torque	: 6.11 kgfm	Approx. weight <sup>3</sup>	: 188 kg
Locked rotor torque	: 380 %		
Breakdown torque	: 380 %		
Insulation class	: F		
Service factor	: 1.25		
Moment of inertia (J)	: 0.1192 kgm <sup>2</sup>		
Design	: N		

Output	50%	75%	100%	Foundation loads	
Efficiency (%)	90.2	91.7	92.4	Max. traction	: 238 kgf
Power Factor	0.71	0.81	0.85	Max. compression	: 426 kgf

Losses at normative operating points (speed;torque), in percentage of rated output power

P1 (0,9;1,0)	P2 (0,5;1,0)	P3 (0,25;1,0)	P4 (0,9;0,5)	P5 (0,5;0,5)	P6 (0,5;0,25)	P7 (0,25;0,25)
7.7	5.5	4.8	4.7	2.7	2.0	1.2

		<u>Drive end</u>	<u>Non drive end</u>
Bearing type	:	6311 C3	6211 C3
Sealing	:	V'Ring	V'Ring
Lubrication interval	:	14000 h	17000 h
Lubricant amount	:	18 g	11 g
Lubricant type	:	Mobil Polyrex EM	

Notes

This revision replaces and cancel the previous one, which must be eliminated.

- (1) Looking the motor from the shaft end.
- (2) Measured at 1m and with tolerance of +3dB(A).
- (3) Approximate weight subject to changes after manufacturing process.
- (4) At 100% of full load.

These are average values based on tests with sinusoidal power supply, subject to the tolerances stipulated in NEMA MG-1.

Rev.	Changes Summary	Performed	Checked	Date
Performed by				
Checked by			Page	Revision
Date	25/10/2024		1 / 2	

# LOAD PERFORMANCE CURVE

Three Phase Induction Motor - Squirrel Cage



Customer :

Product line : W22 Tru-Metric IE3 Three-Phase Product code : 11989184

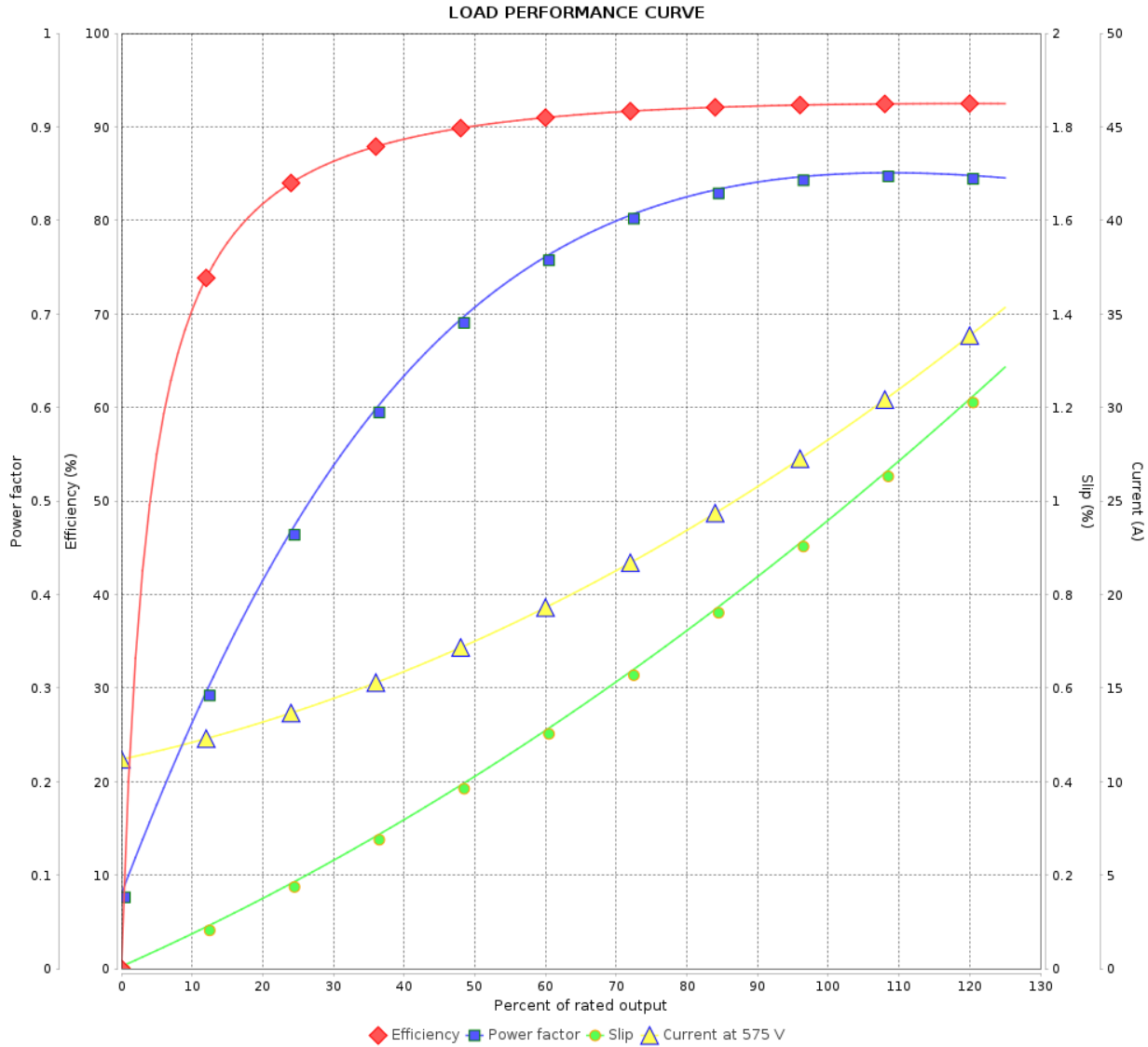

Performance : 575 V 60 Hz 2P

Rated current	: 28.2 A	Moment of inertia (J)	: 0.1192 kgm <sup>2</sup>
LRC	: 9.7	Duty cycle	: S1
Rated torque	: 6.11 kgfm	Insulation class	: F
Locked rotor torque	: 380 %	Service factor	: 1.25
Breakdown torque	: 380 %	Temperature rise	: 80 K
Rated speed	: 3565 rpm	Design	: N

Rev.	Changes Summary	Performed	Checked	Date
Performed by			Page 2 / 2	Revision
Checked by				
Date	25/10/2024			

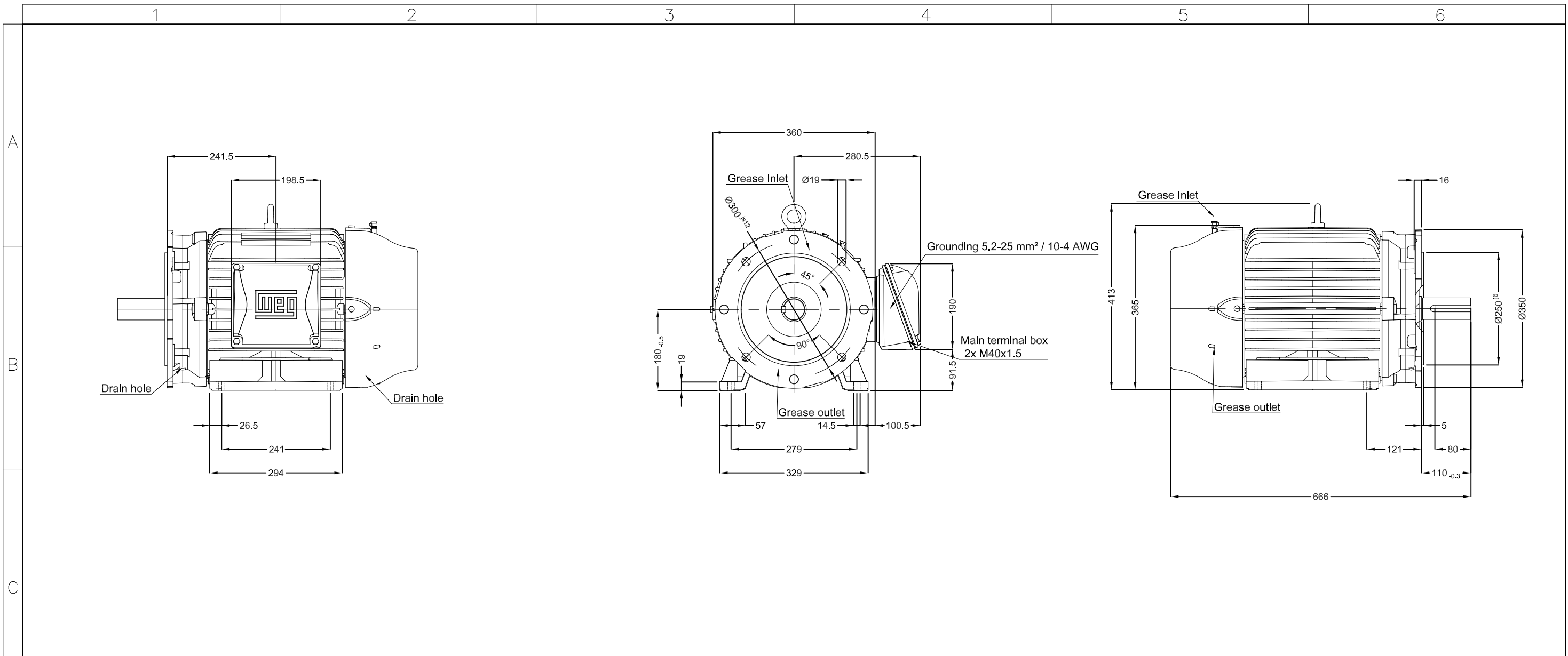

Without vertical jackscrews  
 Color RAL 5009  
 Painting plan 203A  
 Mounting B35L(E)

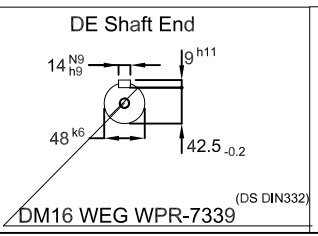

30 HP 02 Poles 60 Hz						A
ECM	LOC	SUMMARY OF MODIFICATIONS			HYBRISUSER	00
EXECUTED	HYBRISUSER	THREE PH. MOTOR W22 IE3	EXECUTED	CHECKED	RELEASED	DATE
CHECKED		FRAME 180M IP55 TEFC				
RELEASED						
REL. DATE						
			PREVIEW		WEG	
			WDD 00		SHEET /	