

DATA SHEET

Three Phase Induction Motor - Squirrel Cage



Customer :

Product line : Close Coupled Pump NEMA Premium Efficiency Three-Phase Product code : 11083738

Frame	: 256JP	Locked rotor time	: 21s (cold) 12s (hot)
Output	: 20 HP (15 kW)	Temperature rise	: 80 K
Poles	: 4	Duty cycle	: Cont.(S1)
Frequency	: 60 Hz	Ambient temperature	: -20°C to +40°C
Rated voltage	: 575 V	Altitude	: 1000 m.a.s.l.
Rated current	: 19.8 A	Protection degree	: IP23
L. R. Amperes	: 124 A	Cooling method	: IC01 - ODP
LRC	: 6.3x(Code G)	Mounting	: F-1
No load current	: 9.60 A	Rotation ¹	: Both (CW and CCW)
Rated speed	: 1770 rpm	Noise level ²	: 60.0 dB(A)
Slip	: 1.67 %	Starting method	: Direct On Line
Rated torque	: 8.20 kgfm	Approx. weight ³	: 128 kg
Locked rotor torque	: 260 %		
Breakdown torque	: 280 %		
Insulation class	: F		
Service factor	: 1.15		
Moment of inertia (J)	: 0.1104 kgm ²		
Design	: B		

Output	50%	75%	100%	Foundation loads	
Efficiency (%)	91.7	93.0	93.0	Max. traction	: 297 kgf
Power Factor	0.63	0.72	0.82	Max. compression	: 425 kgf

		<u>Drive end</u>	<u>Non drive end</u>
Bearing type	:	6309 Z C3	6209 Z C3
Sealing	:	Without Bearing Seal	Without Bearing Seal
Lubrication interval	:	20000 h	20000 h
Lubricant amount	:	13 g	9 g
Lubricant type	:	Mobil Polyrex EM	

Notes

This revision replaces and cancel the previous one, which must be eliminated.

- (1) Looking the motor from the shaft end.
- (2) Measured at 1m and with tolerance of +3dB(A).
- (3) Approximate weight subject to changes after manufacturing process.
- (4) At 100% of full load.

These are average values based on tests with sinusoidal power supply, subject to the tolerances stipulated in NEMA MG-1.

Rev.	Changes Summary	Performed	Checked	Date
Performed by		Page 1 / 2 Revision		
Checked by				
Date	24/10/2024			

LOAD PERFORMANCE CURVE

Three Phase Induction Motor - Squirrel Cage



Customer :

Product line : Close Coupled Pump NEMA
Premium Efficiency Three-Phase

Product code : 11083738

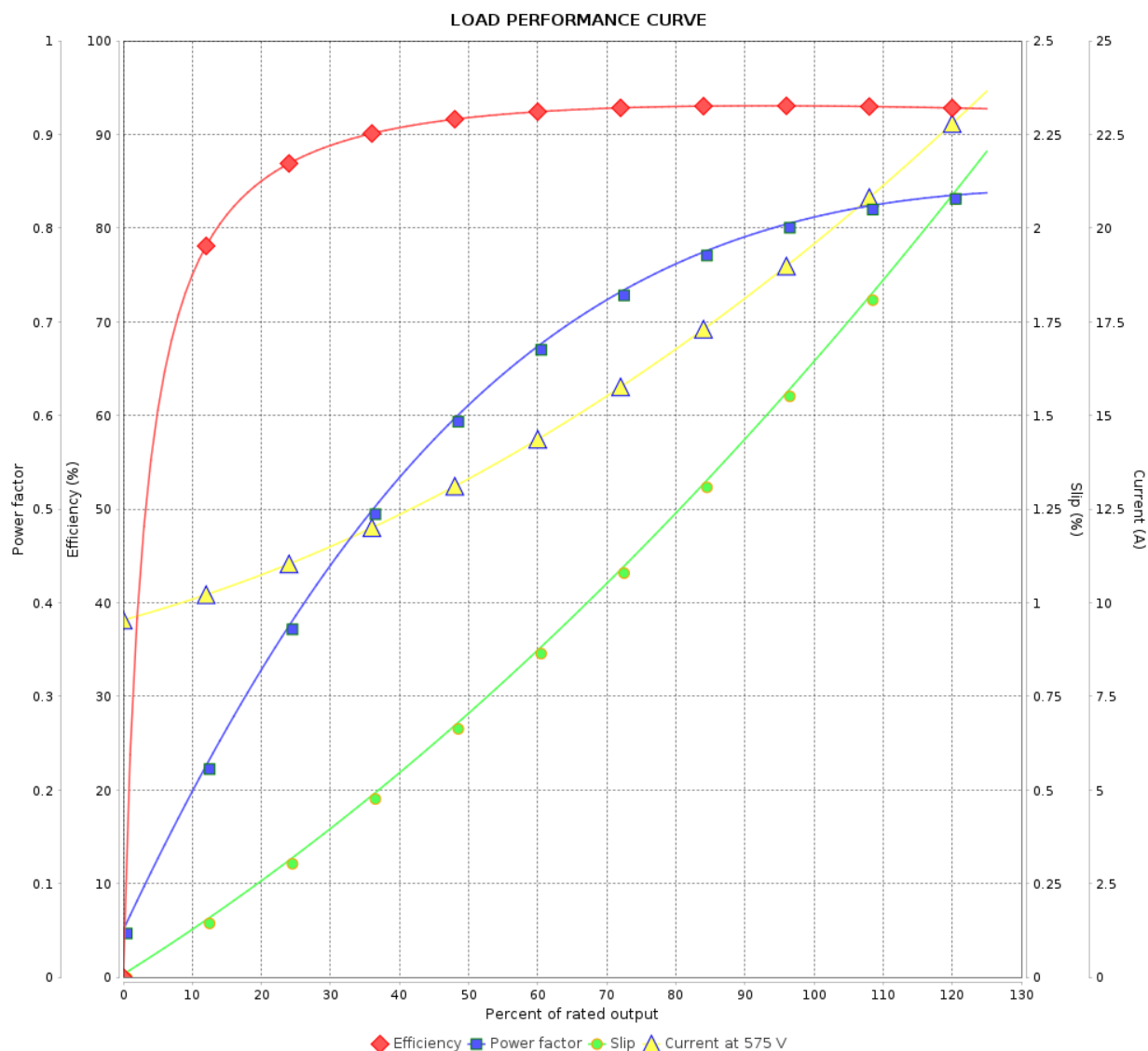

Performance : 575 V 60 Hz 4P

Rated current : 19.8 A
LRC : 6.3
Rated torque : 8.20 kgfm
Locked rotor torque : 260 %
Breakdown torque : 280 %
Rated speed : 1770 rpm

Moment of inertia (J) : 0.1104 kgm²
Duty cycle : Cont.(S1)
Insulation class : F
Service factor : 1.15
Temperature rise : 80 K
Design : B

Rev.	Changes Summary		Performed	Checked	Date
Performed by				Page	Revision
Checked by				2 / 2	
Date					

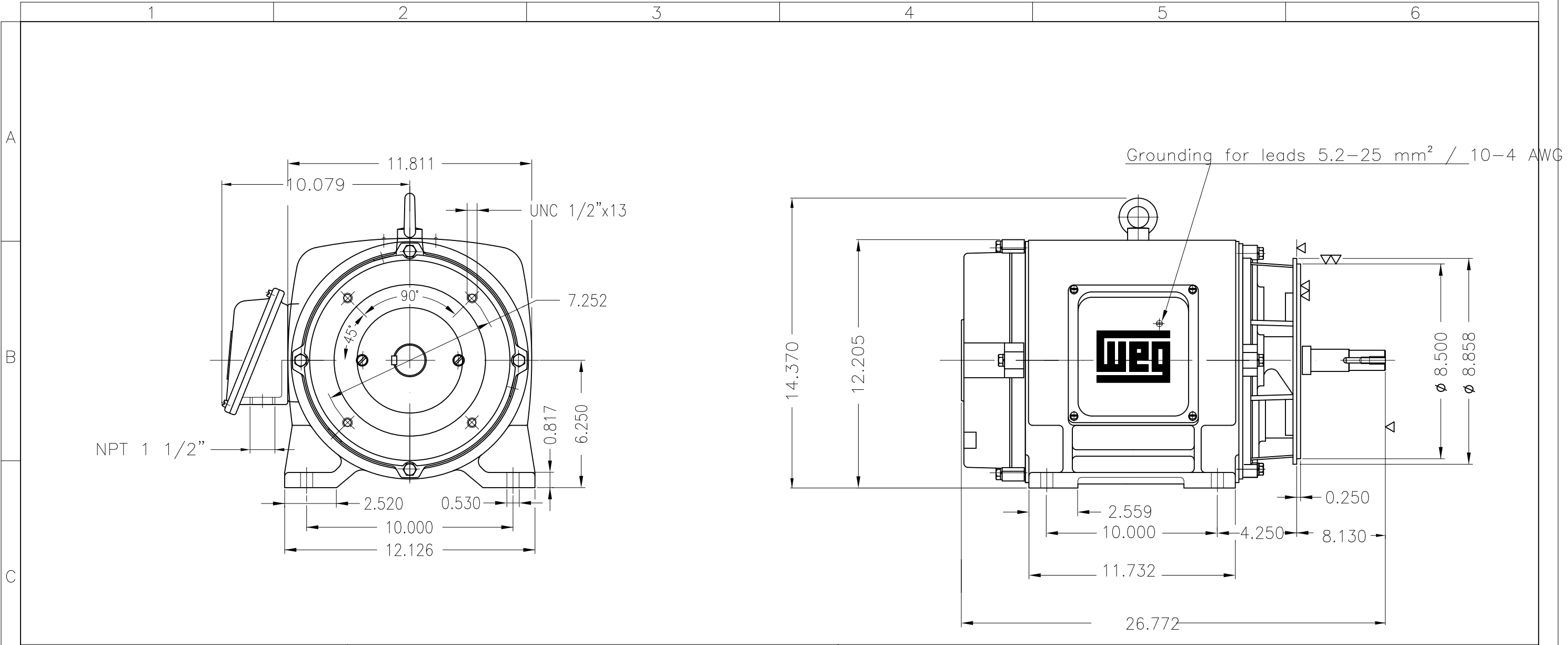

D						
E						
Color RAL 5009						
Painting plan 203A						
Mounting NEMA F-1						
Mounting B34R(D)						

20 HP 04 Poles 60 Hz										A	
</											