

# DATA SHEET



## Three Phase Induction Motor - Squirrel Cage

Customer :						
Product line		: W22 NEMA Premium Efficiency Three-Phase		Product code :		11164522
Frame	: 364/5T			Locked rotor time	: 25s (cold) 14s (hot)	
Output	: 75 HP (55 kW)			Temperature rise	: 80 K	
Poles	: 4			Duty cycle	: Cont.(S1)	
Frequency	: 60 Hz			Ambient temperature	: -20°C to +40°C	
Rated voltage	: 575 V			Altitude	: 1000 m.a.s.l.	
Rated current	: 69.8 A			Protection degree	: IP55	
L. R. Amperes	: 446 A			Cooling method	: IC411 - TEFC	
LRC	: 6.4x(Code G)			Mounting	: F-1	
No load current	: 26.4 A			Rotation <sup>1</sup>	: Both (CW and CCW)	
Rated speed	: 1780 rpm			Noise level <sup>2</sup>	: 67.0 dB(A)	
Slip	: 1.11 %			Starting method	: Direct On Line	
Rated torque	: 30.6 kgfm			Approx. weight <sup>3</sup>	: 412 kg	
Locked rotor torque	: 240 %					
Breakdown torque	: 260 %					
Insulation class	: F					
Service factor	: 1.25					
Moment of inertia (J)	: 0.9798 kgm <sup>2</sup>					
Design	: B					
Output	25%	50%	75%	100%	Foundation loads	
Efficiency (%)	0.000	94.5	95.0	95.4	Max. traction : 687 kgf	
Power Factor	0.00	0.68	0.78	0.83	Max. compression : 1099 kgf	
Losses at normative operating points (speed;torque), in percentage of rated output power						
P1 (0,9;1,0)	P2 (0,5;1,0)	P3 (0,25;1,0)	P4 (0,9;0,5)	P5 (0,5;0,5)	P6 (0,5;0,25)	P7 (0,25;0,25)
4.7	3.8	3.5	2.4	1.6	1.1	0.7
		<u>Drive end</u>		<u>Non drive end</u>		
Bearing type	:	6314 C3		6314 C3		
Sealing	:	WSeal		WSeal		
Lubrication interval	:	12000 h		12000 h		
Lubricant amount	:	27 g		27 g		
Lubricant type	:	Mobil Polyrex EM				
Notes						
This revision replaces and cancel the previous one, which must be eliminated. (1) Looking the motor from the shaft end. (2) Measured at 1m and with tolerance of +3dB(A). (3) Approximate weight subject to changes after manufacturing process. (4) At 100% of full load.				These are average values based on tests with sinusoidal power supply, subject to the tolerances stipulated in NEMA MG-1.		
Rev.	Changes Summary			Performed	Checked	Date
Performed by						
Checked by					Page	Revision
Date	21/10/2024				1 / 2	

# LOAD PERFORMANCE CURVE

Three Phase Induction Motor - Squirrel Cage



Customer : \_\_\_\_\_

Product line : W22 NEMA Premium Efficiency Three-Phase      Product code : 11164522

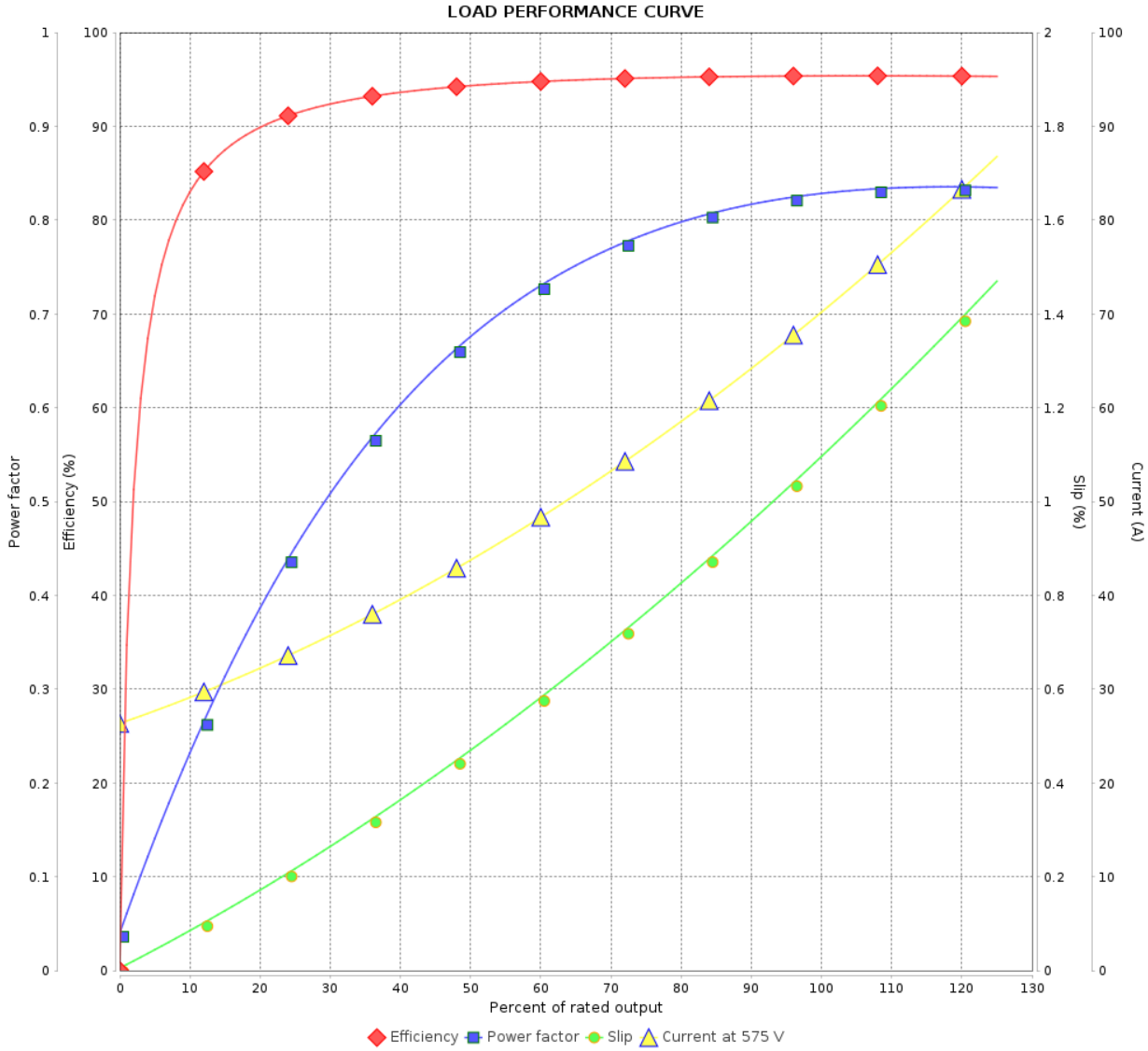

Performance : 575 V 60 Hz 4P

Rated current	: 69.8 A	Moment of inertia (J)	: 0.9798 kgm <sup>2</sup>
LRC	: 6.4	Duty cycle	: Cont.(S1)
Rated torque	: 30.6 kgfm	Insulation class	: F
Locked rotor torque	: 240 %	Service factor	: 1.25
Breakdown torque	: 260 %	Temperature rise	: 80 K
Rated speed	: 1780 rpm	Design	: B

Rev.	Changes Summary	Performed	Checked	Date
Performed by			Page 2 / 2	Revision
Checked by				
Date	21/10/2024			

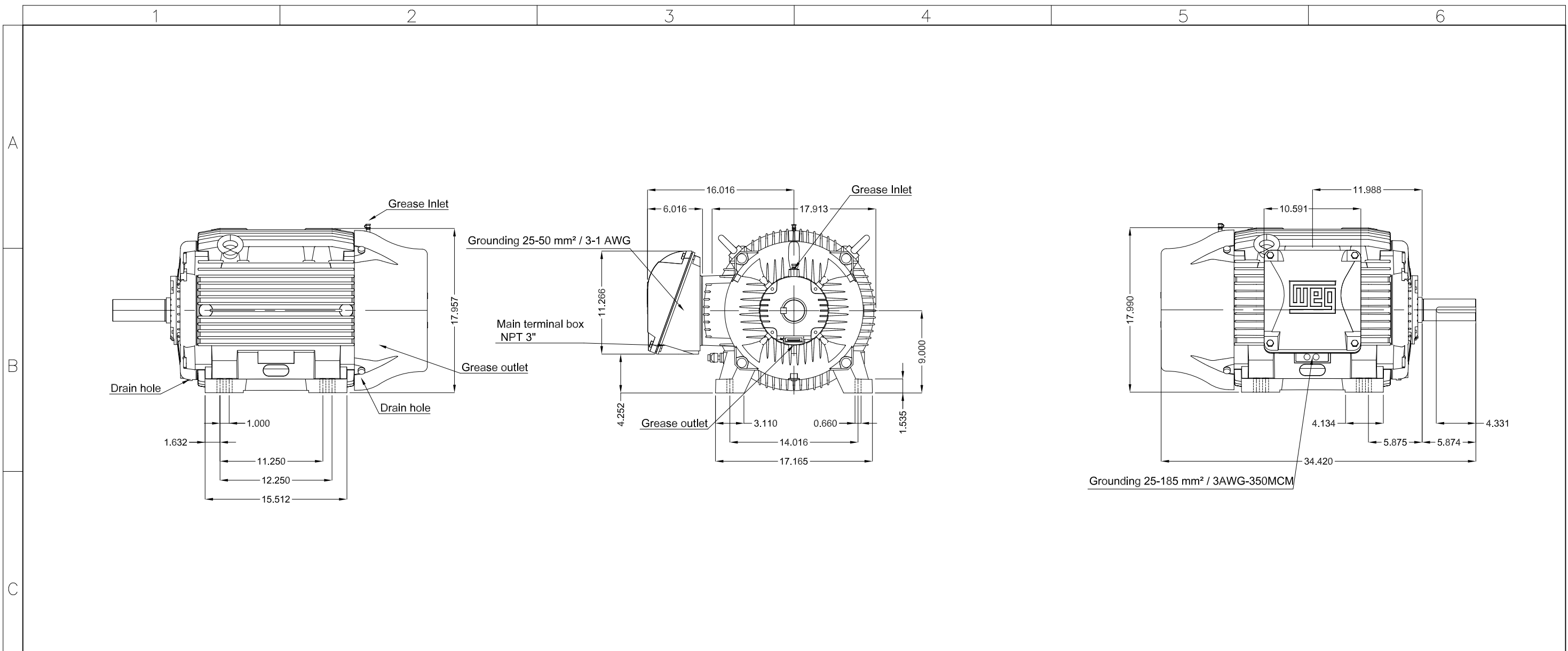

D

E

Color RAL 5009  
 Painting plan 203A  
 Mounting B3R(D)

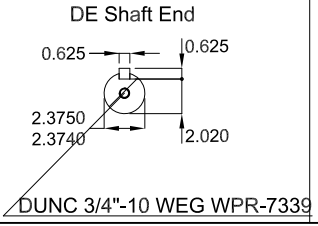

75 HP 04 Poles 60 Hz										A
					HYBRISUSER					00
ECM	LOC	SUMMARY OF MODIFICATIONS			EXECUTED	CHECKED	RELEASED	DATE	VER	
EXECUTED	HYBRISUSER	THREE PH. MOTOR W22 NEMA PREM. EFF.								
CHECKED		FRAME 364/5T IP55 TEFC								
RELEASED										
REL. DATE										
								PREVIEW		
								WDD 00		
								SHEET /		

Dimensions in inches

A3