

DATA SHEET

Three Phase Induction Motor - Squirrel Cage



Customer :

Product line : ODP NEMA Premium Efficiency Three-Phase Product code : 11997391

Frame	: 324TC	Cooling method	: IC01 - ODP
Insulation class	: F	Mounting	: F-1
Duty cycle	: Cont.(S1)	Rotation ¹	: Both (CW and CCW)
Ambient temperature	: -20°C to +40°C	Starting method	: Direct On Line
Altitude	: 1000 m.a.s.l.	Approx. weight ³	: 218 kg
Protection degree	: IP23	Moment of inertia (J)	: 0.2551 kgm ²
Design	: B		

Output [HP]	40	30	30	30	40	40	40
Poles	4	4	4	4	4	4	4
Frequency [Hz]	60	50	50	50	50	50	50
Rated voltage [V]	230/460	380	400	415	380	400	415
Rated current [A]	96.4/48.2	42.8	41.6	41.1	58.1	55.8	54.4
L. R. Amperes [A]	598/299	270	291	312	279	301	321
LRC [A]	6.2x(Code G)	6.3x(Code G)	7.0x(Code H)	7.6x(Code J)	4.8x(Code E)	5.4x(Code F)	5.9x(Code G)
No load current [A]	37.0/18.5	15.4	16.8	18.1	15.4	16.8	18.1
Rated speed [RPM]	1775	1475	1475	1480	1465	1470	1475
Slip [%]	1.39	1.67	1.67	1.33	2.33	2.00	1.67
Rated torque [kgfm]	16.4	14.8	14.8	14.7	19.8	19.7	19.7
Locked rotor torque [%]	220	240	270	290	180	200	220
Breakdown torque [%]	229	340	370	400	250	280	300
Service factor	1.15	1.15	1.15	1.15	1.15	1.15	1.15
Temperature rise	80 K	80 K	80 K	80 K	80 K	80 K	80 K
Locked rotor time	50s (cold) 28s (hot)	36s (cold) 20s (hot)	32s (cold) 18s (hot)	30s (cold) 17s (hot)	36s (cold) 20s (hot)	32s (cold) 18s (hot)	30s (cold) 17s (hot)
Noise level ²	64.0 dB(A)						
Efficiency (%)	25%						
	50%	93.6	90.1	89.9	89.8	91.7	91.7
	75%	94.1	91.7	91.7	92.0	91.7	91.7
	100%	94.1	93.0	93.0	93.0	92.3	92.3
Power Factor	25%						
	50%	0.68	0.70	0.66	0.63	0.77	0.74
	75%	0.78	0.80	0.77	0.74	0.84	0.82
	100%	0.83	0.84	0.82	0.80	0.85	0.84

	<u>Drive end</u>	<u>Non drive end</u>	Foundation loads
Bearing type	: 6312 Z C3	6212 Z C3	Max. traction : 634 kgf
Sealing	: Without	Without	Max. compression : 852 kgf
	Bearing Seal	Bearing Seal	
Lubrication interval	: 20000 h	20000 h	
Lubricant amount	: 21 g	13 g	
Lubricant type	: Mobil Polyrex EM		

Notes
USABLE @208V 107A SF 1.15 SFA 123A

This revision replaces and cancel the previous one, which must be eliminated.
(1) Looking the motor from the shaft end.
(2) Measured at 1m and with tolerance of +3dB(A).
(3) Approximate weight subject to changes after manufacturing process.
(4) At 100% of full load.

These are average values based on tests with sinusoidal power supply, subject to the tolerances stipulated in NEMA MG-1.

Rev.	Changes Summary	Performed	Checked	Date
Performed by				
Checked by				
Date	24/08/2025			

Page 1 / 8
Revision

LOAD PERFORMANCE CURVE

Three Phase Induction Motor - Squirrel Cage



Customer :

Product line : ODP NEMA Premium Efficiency
Three-Phase

Product code : 11997391

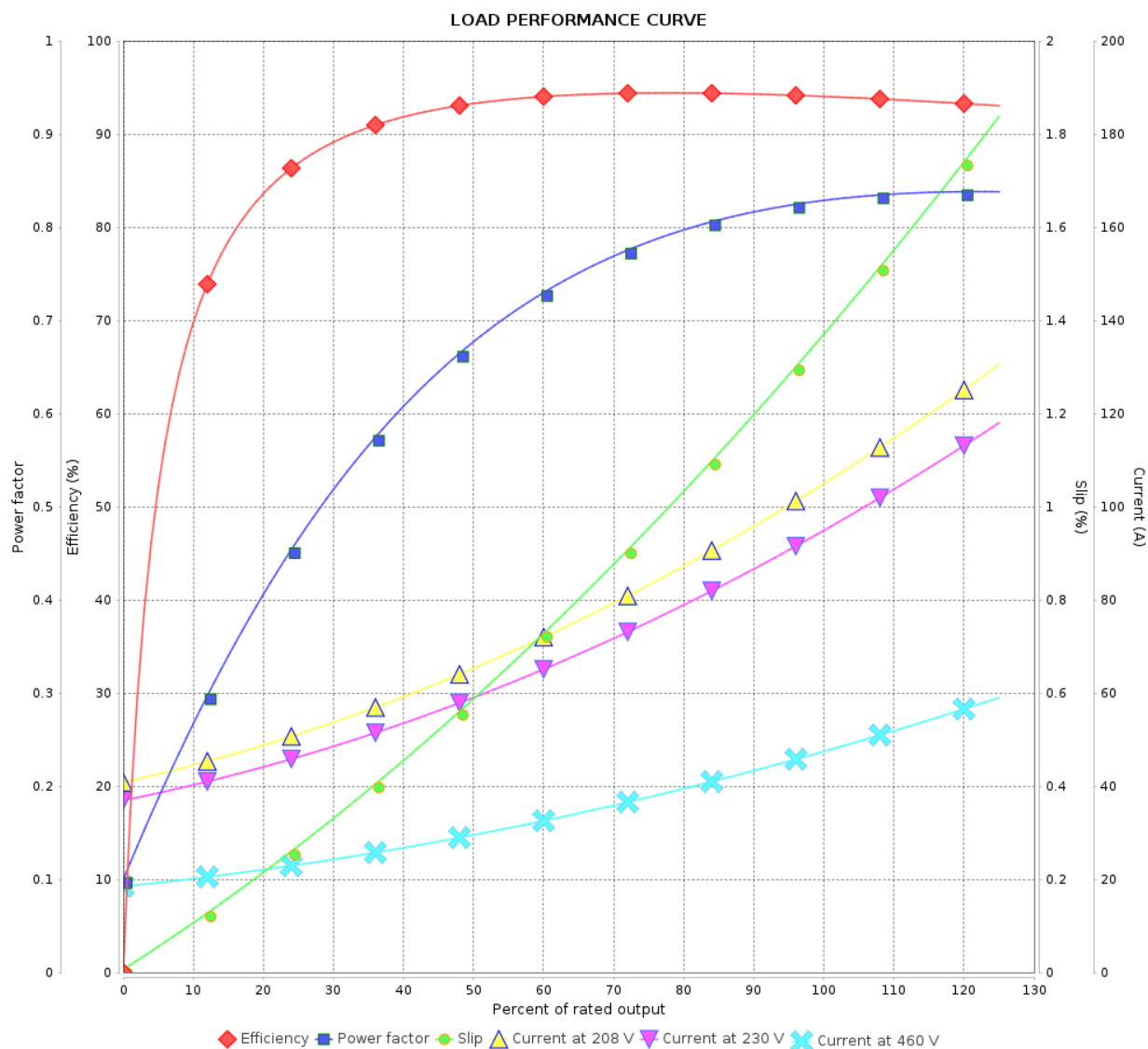

Performance : 230/460 V 60 Hz 4P

Rated current : 96.4/48.2 A
LRC : 6.2
Rated torque : 16.4 kgfm
Locked rotor torque : 220 %
Breakdown torque : 229 %
Rated speed : 1775 rpm

Moment of inertia (J) : 0.2551 kgm²
Duty cycle : Cont.(S1)
Insulation class : F
Service factor : 1.15
Temperature rise : 80 K
Design : B

Rev.	Changes Summary		Performed	Checked	Date
Performed by				Page 2 / 8	Revision
Checked by					
Date	24/08/2025				

LOAD PERFORMANCE CURVE

Three Phase Induction Motor - Squirrel Cage



Customer :

Product line : ODP NEMA Premium Efficiency
Three-Phase

Product code : 11997391

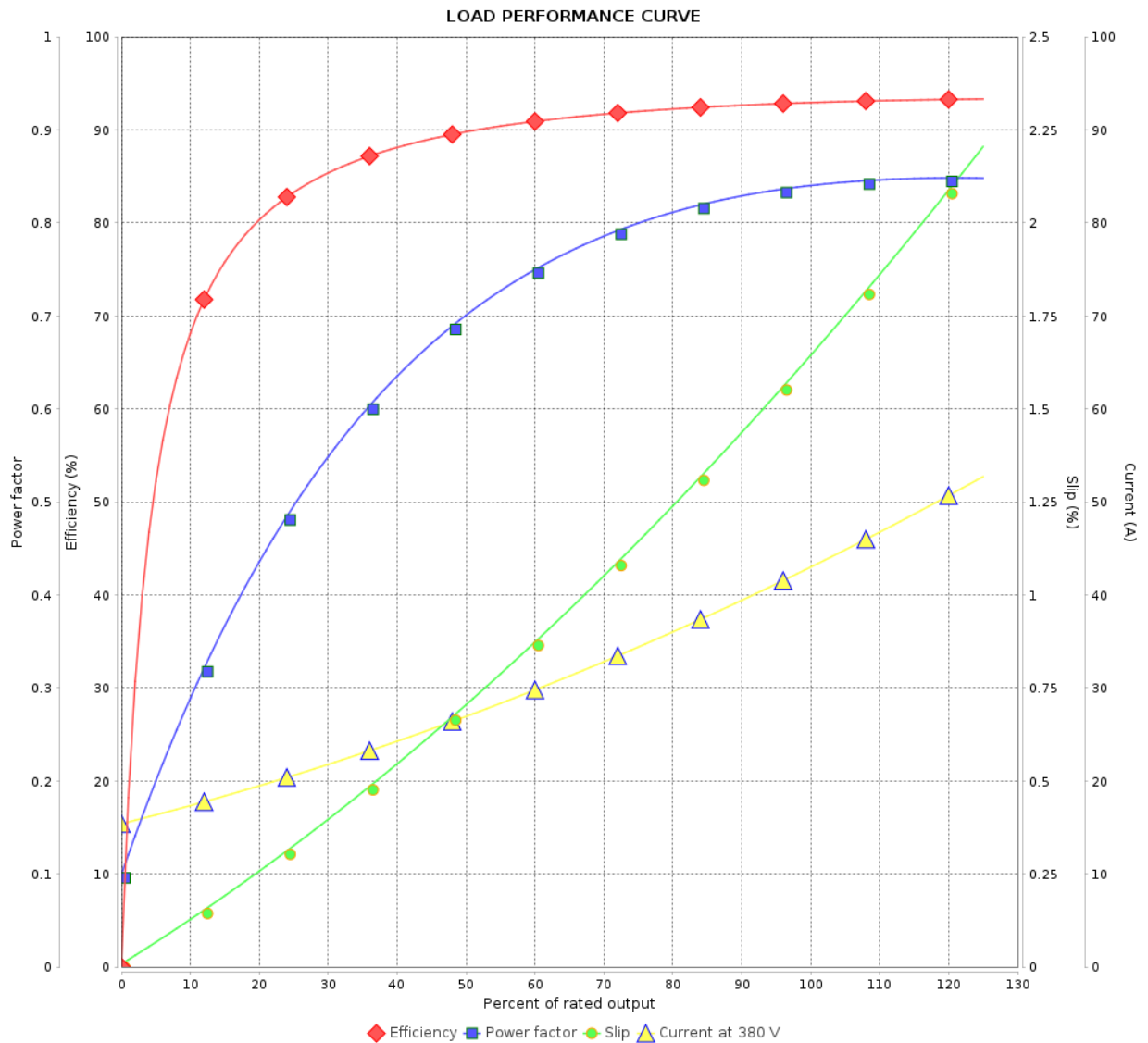

Performance : 380 V 50 Hz 4P IE3

Rated current : 42.8 A
LRC : 6.3
Rated torque : 14.8 kgfm
Locked rotor torque : 240 %
Breakdown torque : 340 %
Rated speed : 1475 rpm

Moment of inertia (J) : 0.2551 kgm²
Duty cycle : Cont.(S1)
Insulation class : F
Service factor : 1.15
Temperature rise : 80 K
Design : B

Rev.	Changes Summary	Performed	Checked	Date
Performed by		Page 3 / 8Revision		
Checked by				
Date	24/08/2025			

LOAD PERFORMANCE CURVE

Three Phase Induction Motor - Squirrel Cage



Customer :

Product line : ODP NEMA Premium Efficiency
Three-Phase

Product code : 11997391

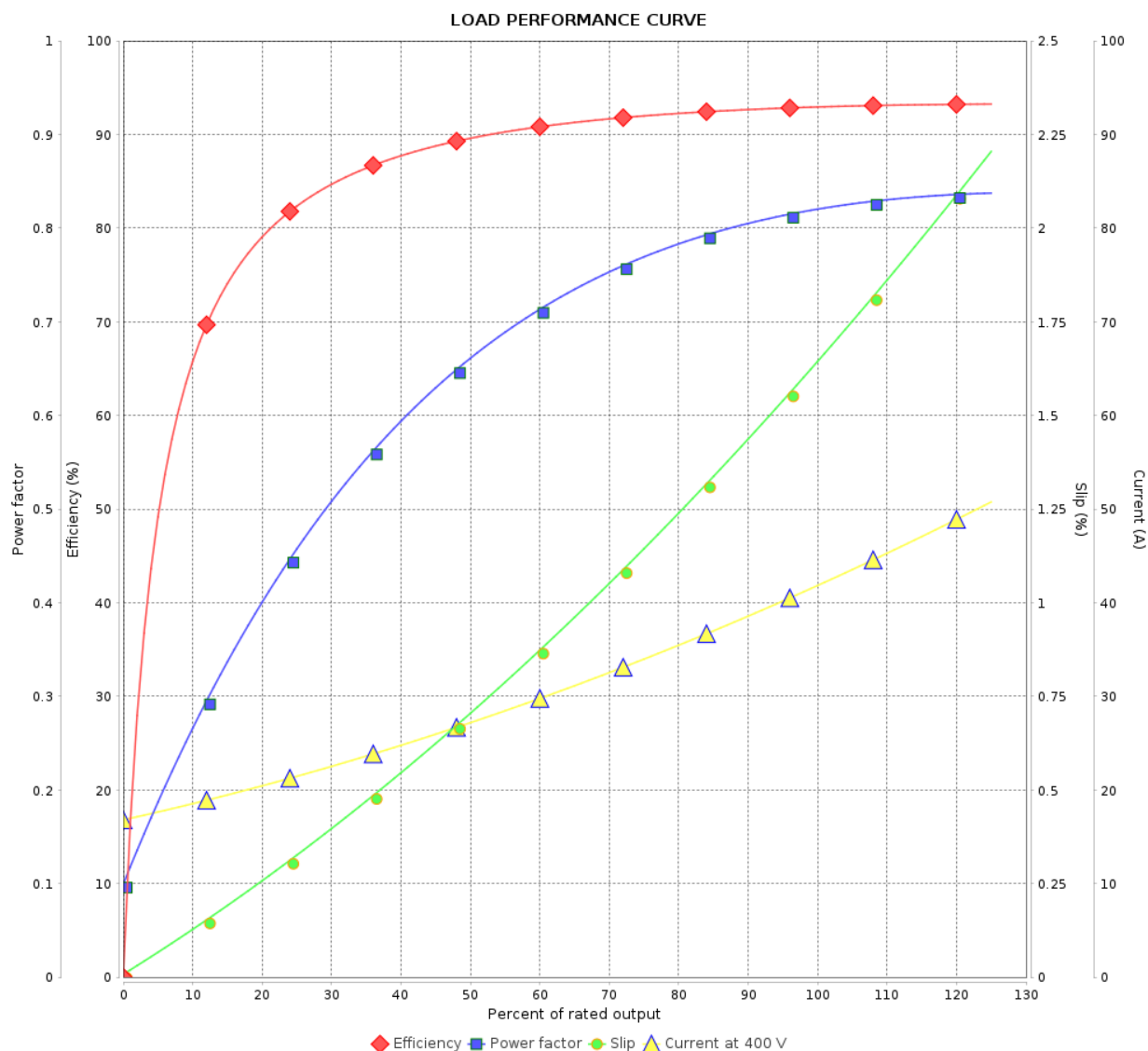

Performance : 400 V 50 Hz 4P IE3

Rated current : 41.6 A
LRC : 7.0
Rated torque : 14.8 kgfm
Locked rotor torque : 270 %
Breakdown torque : 370 %
Rated speed : 1475 rpm

Moment of inertia (J) : 0.2551 kgm²
Duty cycle : Cont.(S1)
Insulation class : F
Service factor : 1.15
Temperature rise : 80 K
Design : B

Rev.	Changes Summary		Performed	Checked	Date
Performed by				Page 4 / 8	Revision
Checked by					
Date	24/08/2025				

LOAD PERFORMANCE CURVE

Three Phase Induction Motor - Squirrel Cage



Customer :

Product line : ODP NEMA Premium Efficiency
Three-Phase

Product code : 11997391

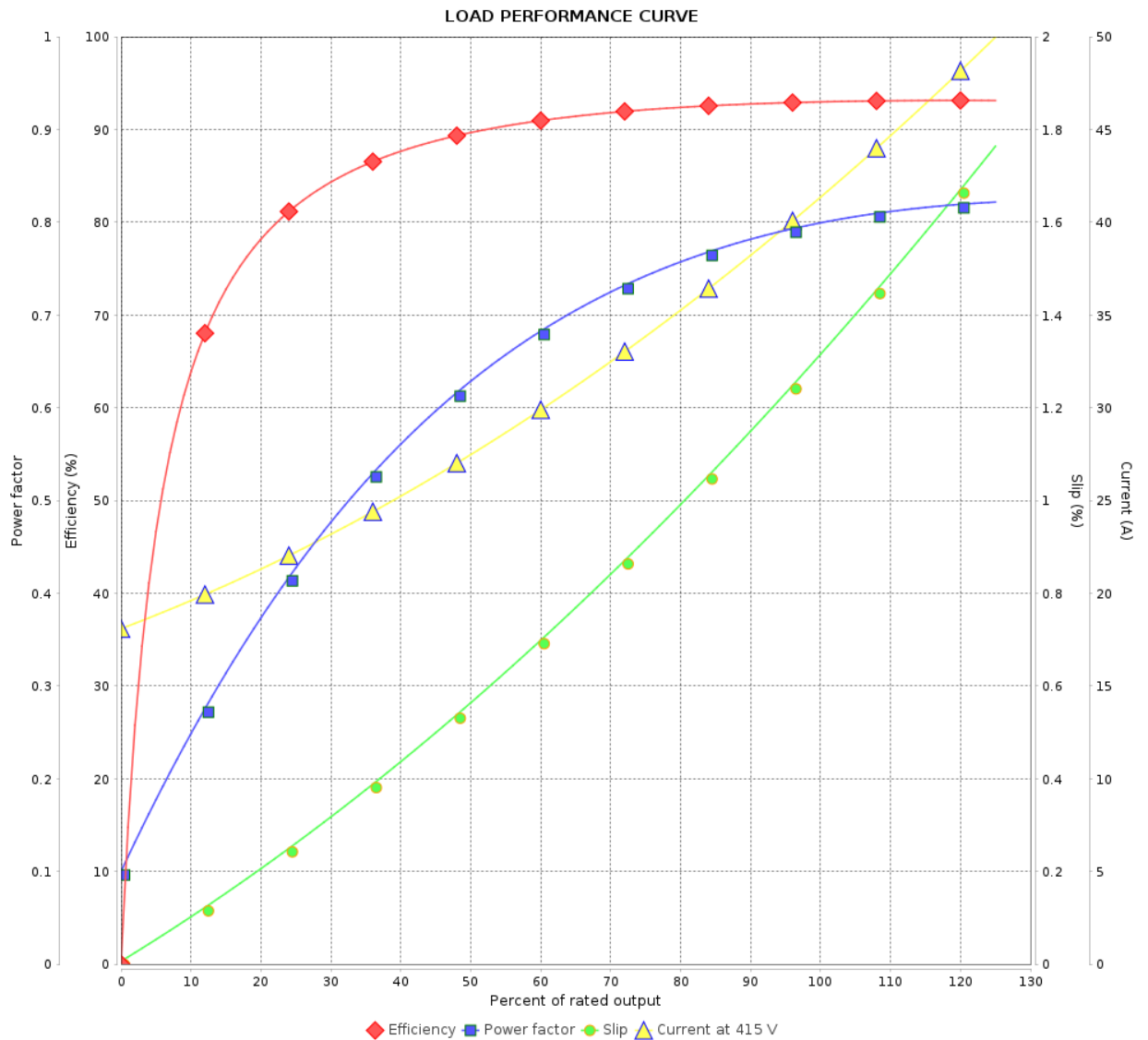

Performance : 415 V 50 Hz 4P IE3

Rated current : 41.1 A
LRC : 7.6
Rated torque : 14.7 kgfm
Locked rotor torque : 290 %
Breakdown torque : 400 %
Rated speed : 1480 rpm

Moment of inertia (J) : 0.2551 kgm²
Duty cycle : Cont.(S1)
Insulation class : F
Service factor : 1.15
Temperature rise : 80 K
Design : B

Rev.	Changes Summary	Performed	Checked	Date
Performed by		Page 5 / 8Revision		
Checked by				
Date	24/08/2025			

LOAD PERFORMANCE CURVE

Three Phase Induction Motor - Squirrel Cage



Customer :

Product line : ODP NEMA Premium Efficiency
Three-Phase

Product code : 11997391

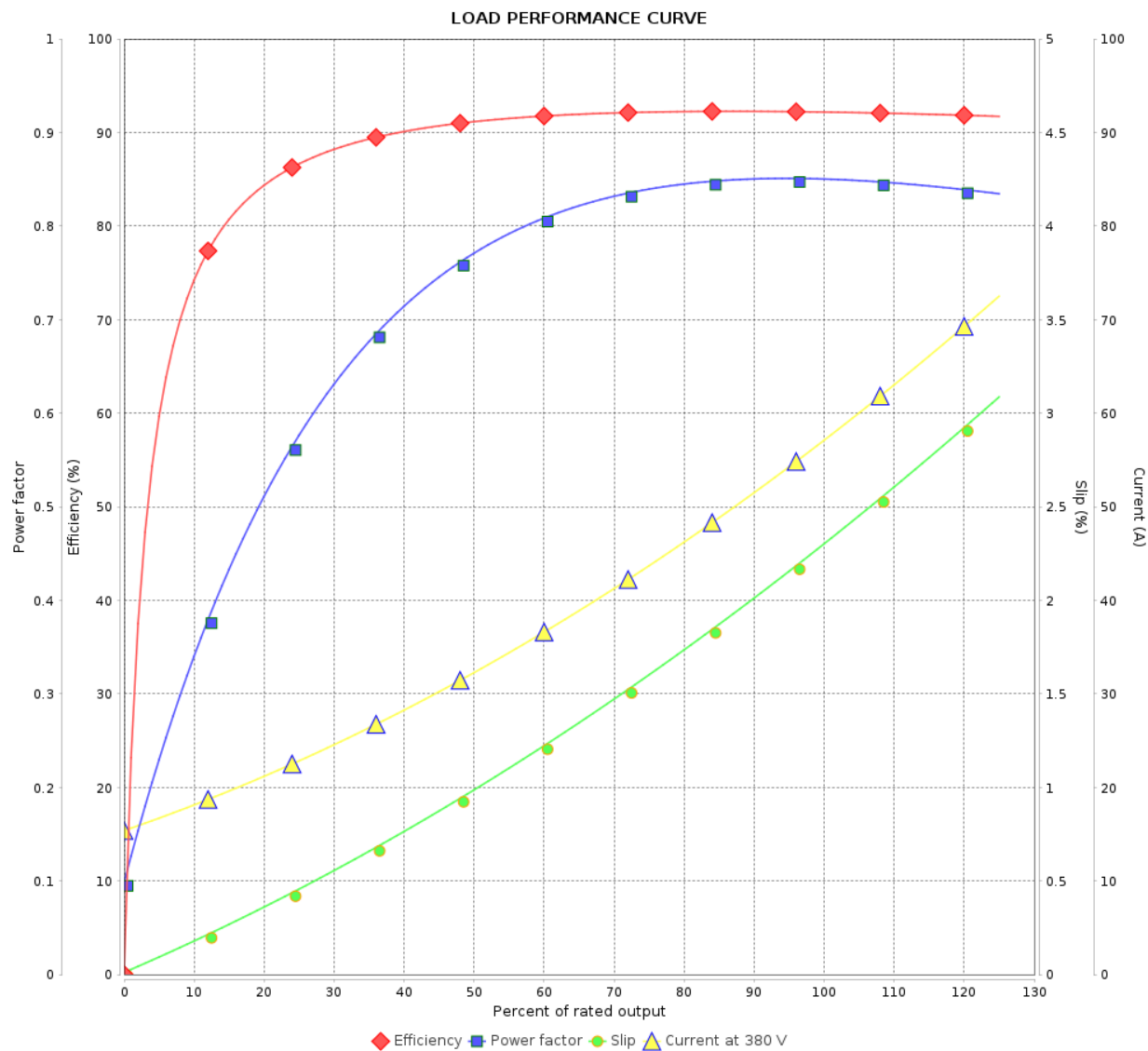

Performance : 380 V 50 Hz 4P IE2

Rated current : 58.1 A
LRC : 4.8
Rated torque : 19.8 kgfm
Locked rotor torque : 180 %
Breakdown torque : 250 %
Rated speed : 1465 rpm

Moment of inertia (J) : 0.2551 kgm²
Duty cycle : Cont.(S1)
Insulation class : F
Service factor : 1.15
Temperature rise : 80 K
Design : B

Rev.	Changes Summary	Performed	Checked	Date
Performed by		Page 6 / 8Revision		
Checked by				
Date	24/08/2025			

LOAD PERFORMANCE CURVE

Three Phase Induction Motor - Squirrel Cage



Customer :

Product line : ODP NEMA Premium Efficiency
Three-Phase

Product code : 11997391

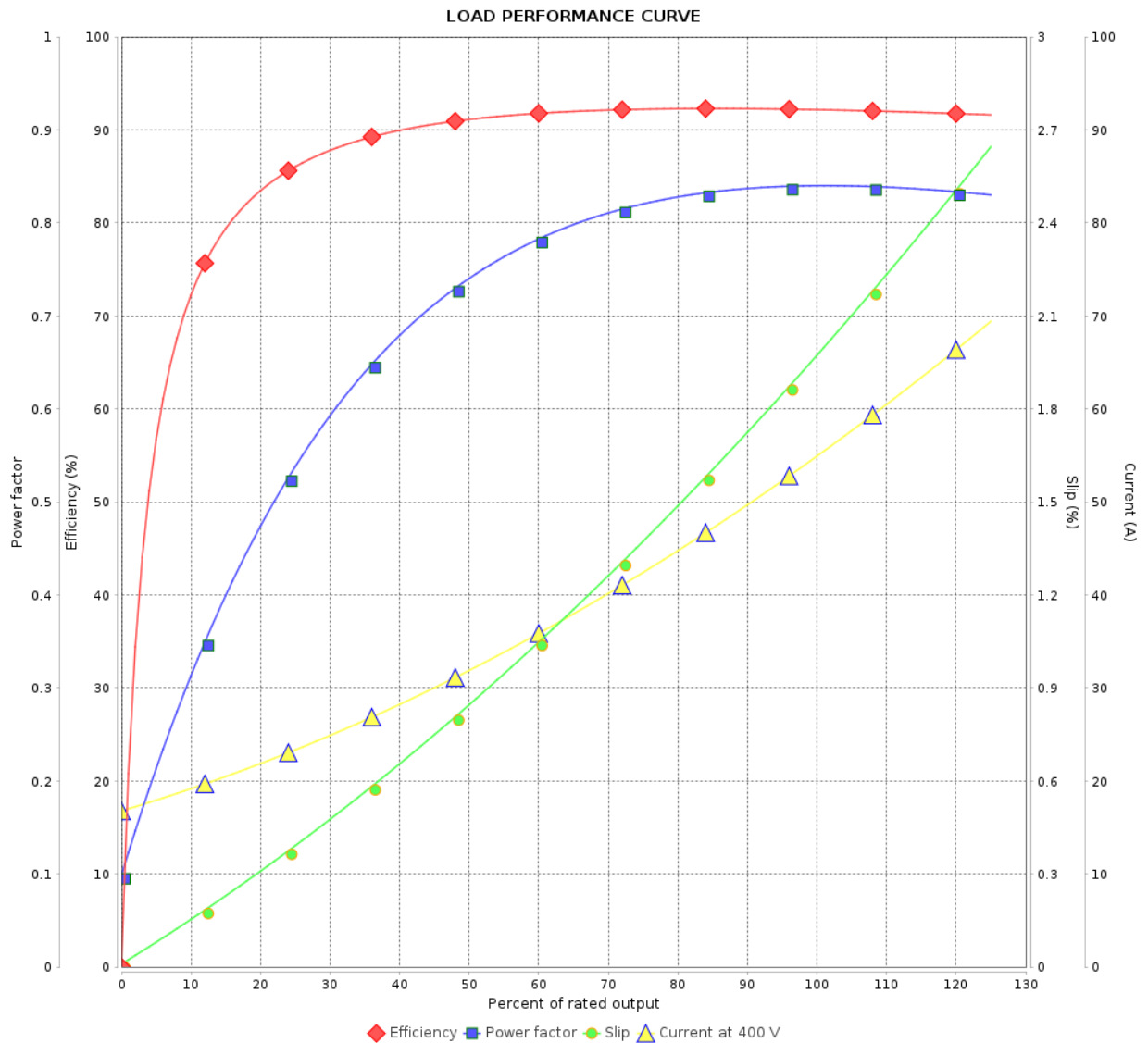

Performance : 400 V 50 Hz 4P IE2

Rated current	: 55.8 A	Moment of inertia (J)	: 0.2551 kgm ²
LRC	: 5.4	Duty cycle	: Cont.(S1)
Rated torque	: 19.7 kgfm	Insulation class	: F
Locked rotor torque	: 200 %	Service factor	: 1.15
Breakdown torque	: 280 %	Temperature rise	: 80 K
Rated speed	: 1470 rpm	Design	: B

Rev.	Changes Summary	Performed	Checked	Date
Performed by				
Checked by				
Date	24/08/2025		Page 7 / 8	Revision

LOAD PERFORMANCE CURVE

Three Phase Induction Motor - Squirrel Cage



Customer :

Product line : ODP NEMA Premium Efficiency
Three-Phase

Product code : 11997391

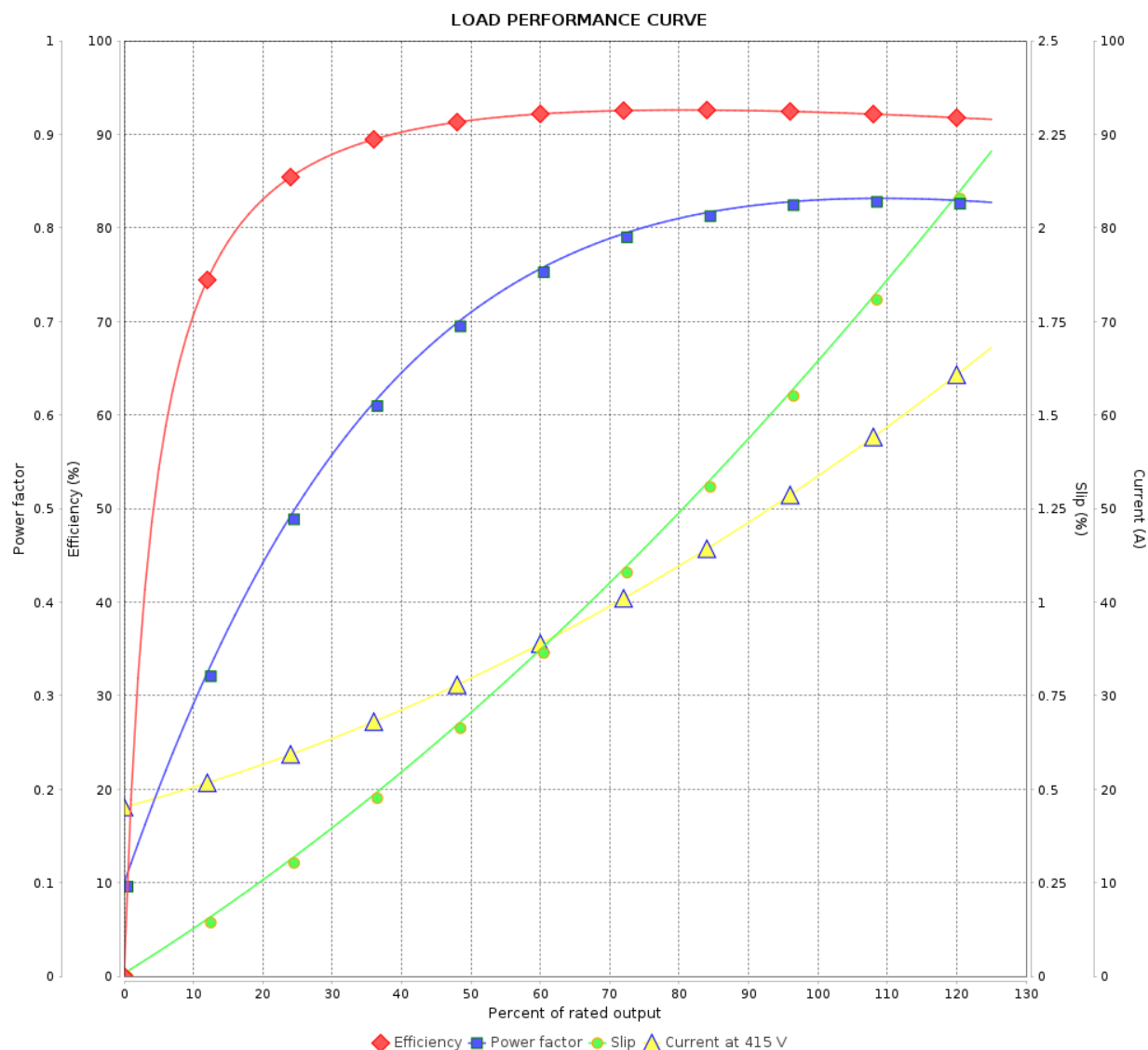

Performance : 415 V 50 Hz 4P IE2

Rated current : 54.4 A
LRC : 5.9
Rated torque : 19.7 kgfm
Locked rotor torque : 220 %
Breakdown torque : 300 %
Rated speed : 1475 rpm

Moment of inertia (J) : 0.2551 kgm²
Duty cycle : Cont.(S1)
Insulation class : F
Service factor : 1.15
Temperature rise : 80 K
Design : B

Rev.	Changes Summary		Performed	Checked	Date
Performed by				Page 8 / 8	Revision
Checked by					
Date	24/08/2025				

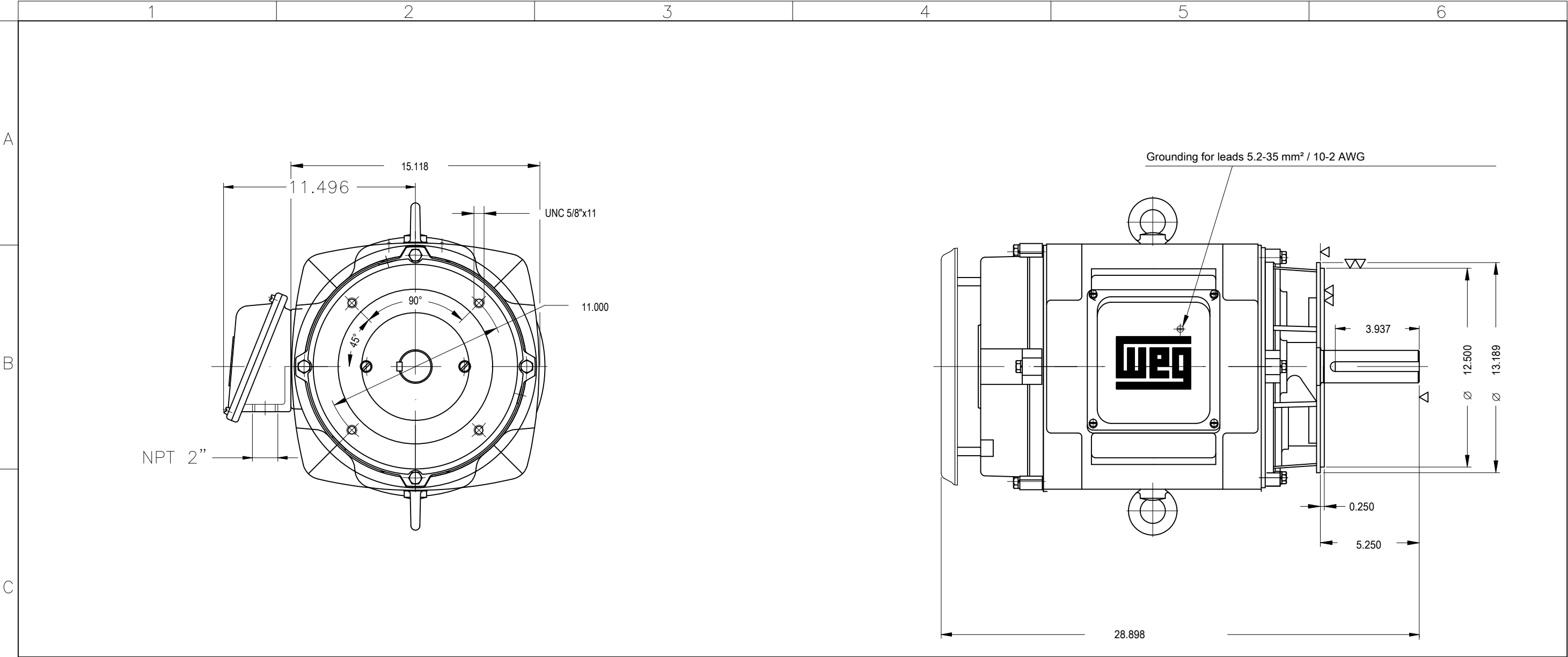

D												
			40 HP 04 Poles 60 Hz							A		

Color RAL 5009
Painting plan 203A
Mounting B14R(D)

