

DATA SHEET

Three Phase Induction Motor - Squirrel Cage



Customer :					
Product line		: Multimounting High Efficiency Three-Phase	Product code : 16122659		
Frame	: 63	Cooling method	: IC411 - TEFC		
Insulation class	: F	Mounting	: B35L(E)		
Duty cycle	: S1	Rotation ¹	: Both (CW and CCW)		
Ambient temperature	: -20°C to +40°C	Starting method	: Direct On Line		
Altitude	: 1000 m.a.s.l.	Approx. weight ³	: 6.0 kg		
Protection degree	: IP55	Moment of inertia (J)	: 0.0001 kgm ²		
Design	: N				
Output [HP]	0.25	0.25	0.25		
Poles	2	2	2		
Frequency [Hz]	50	50	60		
Rated voltage [V]	380	415	230/460		
Rated current [A]	0.518	0.550	1.01/0.504		
L. R. Amperes [A]	2.28	2.42	5.04/2.52		
LRC [A]	4.4	4.4	5.0		
No load current [A]	0.430	0.540	0.900/0.450		
Rated speed [RPM]	2735	2780	3400		
Slip [%]	8.83	7.33	5.56		
Rated torque [kgfm]	0.066	0.065	0.053		
Locked rotor torque [%]	220	270	320		
Breakdown torque [%]	229	280	350		
Service factor	1.00	1.00	1.15		
Temperature rise	80 K	80 K	80 K		
Locked rotor time	36s (cold) 20s (hot)	36s (cold) 20s (hot)	36s (cold) 20s (hot)		
Noise level ²	52.0 dB(A)	52.0 dB(A)	56.0 dB(A)		
Efficiency (%)	25%				
	50%	60.0	58.0	55.0	
	75%	64.0	60.0	62.0	
	100%	66.0	65.0	64.0	
Power Factor	25%				
	50%	0.58	0.48	0.48	
	75%	0.70	0.60	0.60	
	100%	0.80	0.70	0.70	
Bearing type	: <u>Drive end</u> 6201 ZZ <u>Non drive end</u> 6201 ZZ	Foundation loads			
Sealing	: Oil Seal Oil Seal	Max. traction	: 4 kgf		
Lubrication interval	: - -	Max. compression	: 10 kgf		
Lubricant amount	: - -				
Lubricant type	: Mobil Polyrex EM				
Notes					
This revision replaces and cancel the previous one, which must be eliminated. (1) Looking the motor from the shaft end. (2) Measured at 1m and with tolerance of +3dB(A). (3) Approximate weight subject to changes after manufacturing process. (4) At 100% of full load.			These are average values based on tests with sinusoidal power supply, subject to the tolerances stipulated in NEMA MG-1.		
Rev.	Changes Summary		Performed	Checked	Date
Performed by					
Checked by				Page	Revision
Date	30/10/2024			1 / 4	

LOAD PERFORMANCE CURVE

Three Phase Induction Motor - Squirrel Cage



Customer :

Product line : Multimounting High Efficiency Three-Phase

Product code : 16122659

LOAD PERFORMANCE CURVE

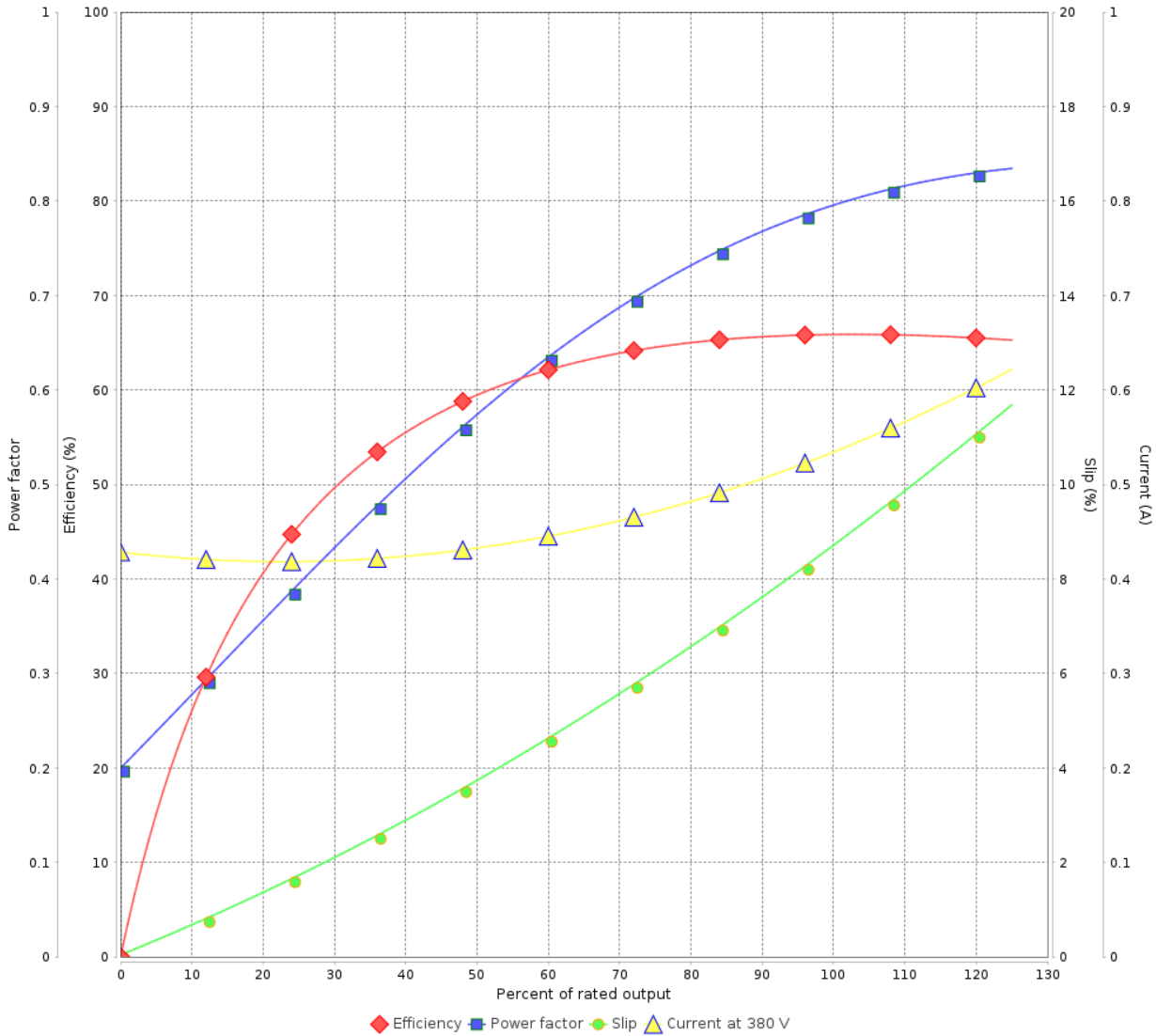

Performance : 380 V 50 Hz 2P

Rated current : 0.518 A
 LRC : 4.4
 Rated torque : 0.066 kgfm
 Locked rotor torque : 220 %
 Breakdown torque : 229 %
 Rated speed : 2735 rpm

Moment of inertia (J) : 0.0001 kgm²
 Duty cycle : S1
 Insulation class : F
 Service factor : 1.00
 Temperature rise : 80 K
 Design : N

Rev.	Changes Summary	Performed	Checked	Date
Performed by			Page 2 / 4	Revision
Checked by				
Date	30/10/2024			

LOAD PERFORMANCE CURVE

Three Phase Induction Motor - Squirrel Cage



Customer : _____

Product line : Multimounting High Efficiency
Three-Phase

Product code : 16122659

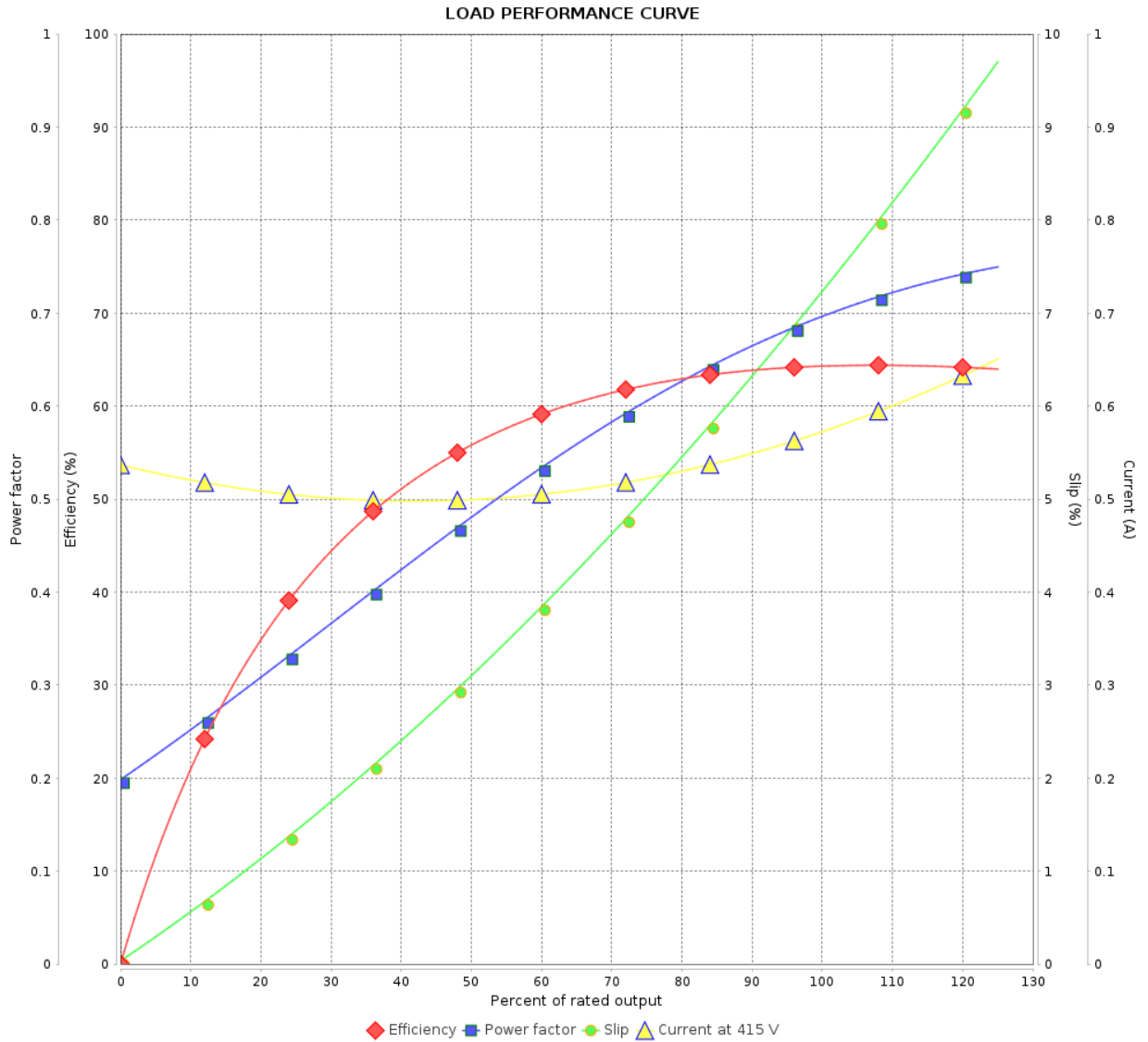

Performance : 415 V 50 Hz 2P

Rated current : 0.550 A
 LRC : 4.4
 Rated torque : 0.065 kgfm
 Locked rotor torque : 270 %
 Breakdown torque : 280 %
 Rated speed : 2780 rpm

Moment of inertia (J) : 0.0001 kgm²
 Duty cycle : S1
 Insulation class : F
 Service factor : 1.00
 Temperature rise : 80 K
 Design : N

Rev.	Changes Summary	Performed	Checked	Date
Performed by		Page		Revision
Checked by		3 / 4		
Date		30/10/2024		

LOAD PERFORMANCE CURVE

Three Phase Induction Motor - Squirrel Cage



Customer :

Product line : Multimounting High Efficiency Three-Phase

Product code : 16122659

LOAD PERFORMANCE CURVE

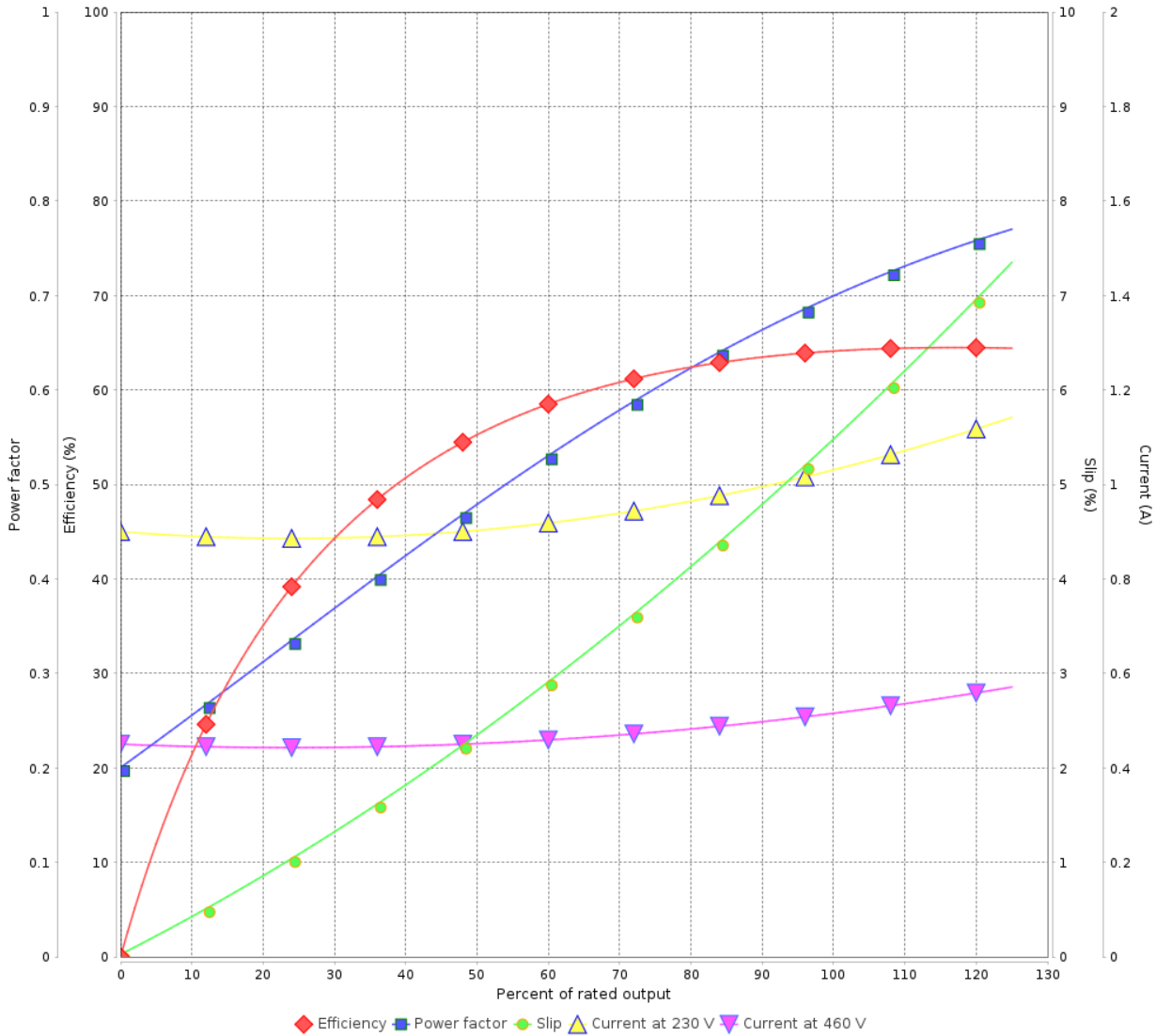

Performance : 230/460 V 60 Hz 2P

Rated current : 1.01/0.504 A
 LRC : 5.0
 Rated torque : 0.053 kgfm
 Locked rotor torque : 320 %
 Breakdown torque : 350 %
 Rated speed : 3400 rpm

Moment of inertia (J) : 0.0001 kgm²
 Duty cycle : S1
 Insulation class : F
 Service factor : 1.15
 Temperature rise : 80 K
 Design : N

Rev.	Changes Summary	Performed	Checked	Date
Performed by			Page 4 / 4	Revision
Checked by				
Date	30/10/2024			

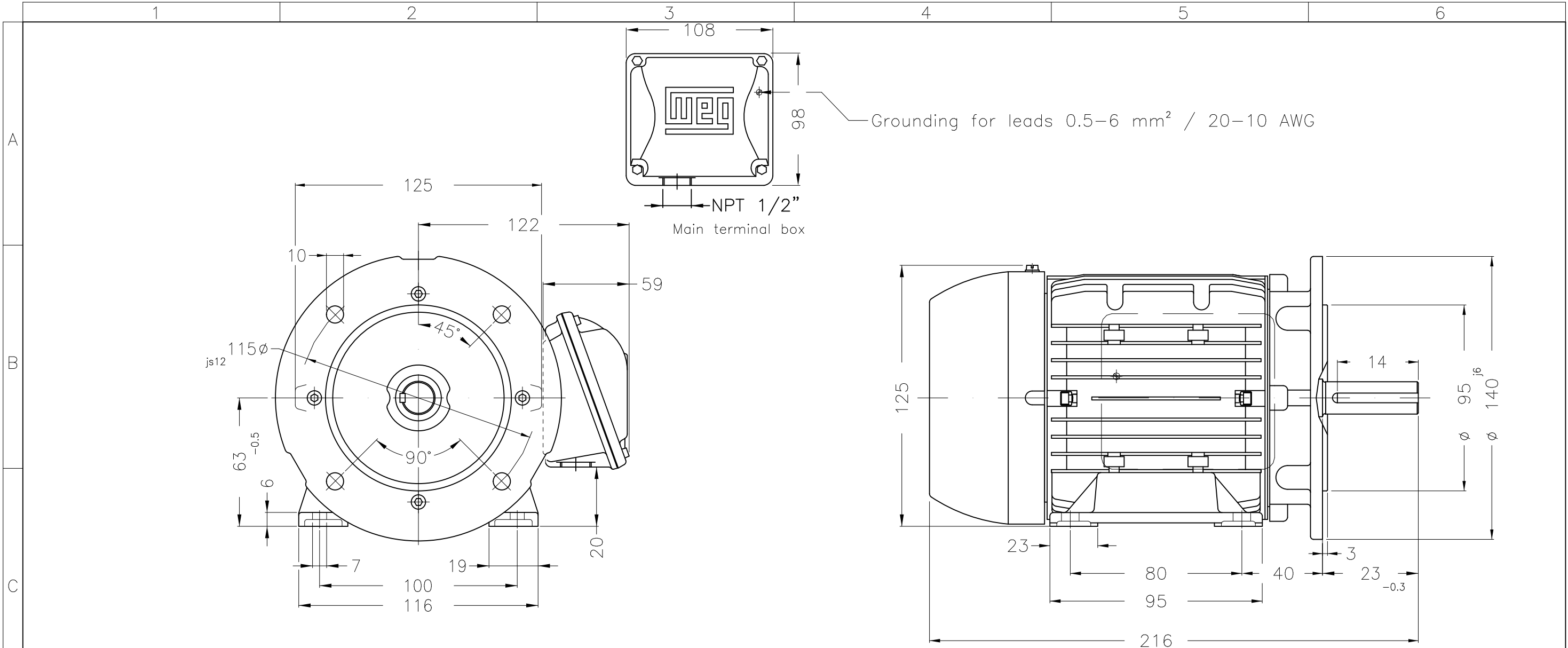

Color RAL 7022

Painting plan 207N

Mounting B35L(E)

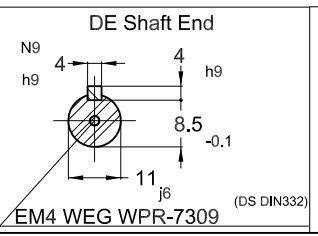

0.25 HP 02 Poles 60 Hz						A			
HYBRISUSER						00			
ECM	LOC	SUMMARY OF MODIFICATIONS			EXECUTED	CHECKED	RELEASED	DATE	VER
EXECUTED	HYBRISUSER	THREE PH. MOTOR MULTIMOUNTIN HIGH EFF.			PREVIEW				
CHECKED		FRAME 63 IP55 TEFC			WDD 00				
RELEASED					SHEET		1 / 1		
REL. DATE		WMO	Jaragua do Sul	Product Engineering					

Dimensions in mm

XME A3