

LOAD PERFORMANCE CURVE

Three Phase Induction Motor - Squirrel Cage



Customer :

Product line : W40 NEMA Premium Efficiency Three-Phase Product code : 14496910

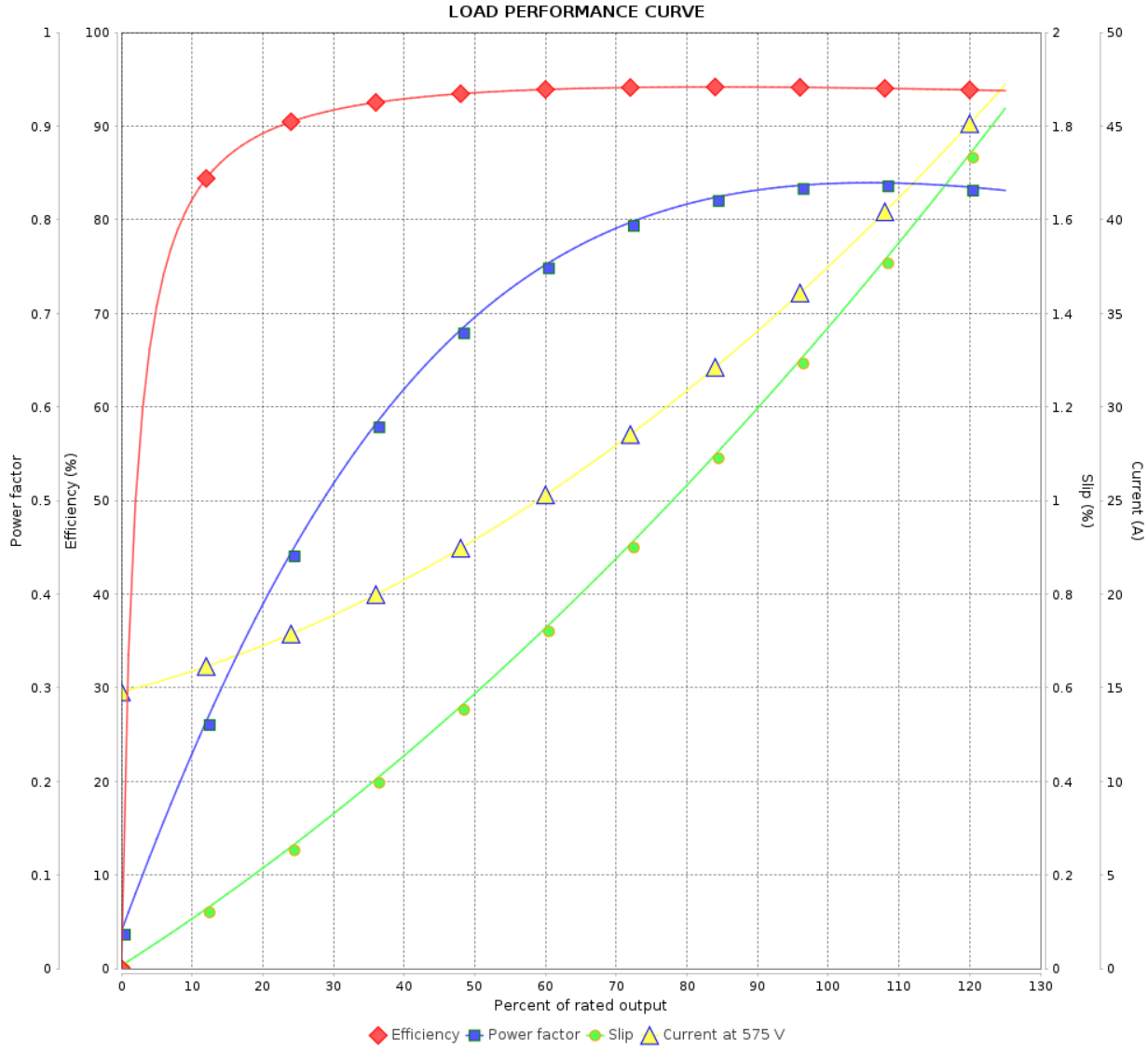

Performance : 575 V 60 Hz 4P

Rated current	: 38.1 A	Moment of inertia (J)	: 0.2397 kgm ²
LRC	: 6.2	Duty cycle	: Cont.(S1)
Rated torque	: 16.4 kgfm	Insulation class	: F
Locked rotor torque	: 200 %	Service factor	: 1.25
Breakdown torque	: 240 %	Temperature rise	: 80 K
Rated speed	: 1775 rpm	Design	: B

Rev.	Changes Summary	Performed	Checked	Date
Performed by		Page		Revision
Checked by		2 / 2		
Date	30/10/2024			

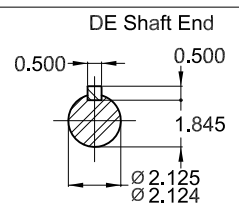
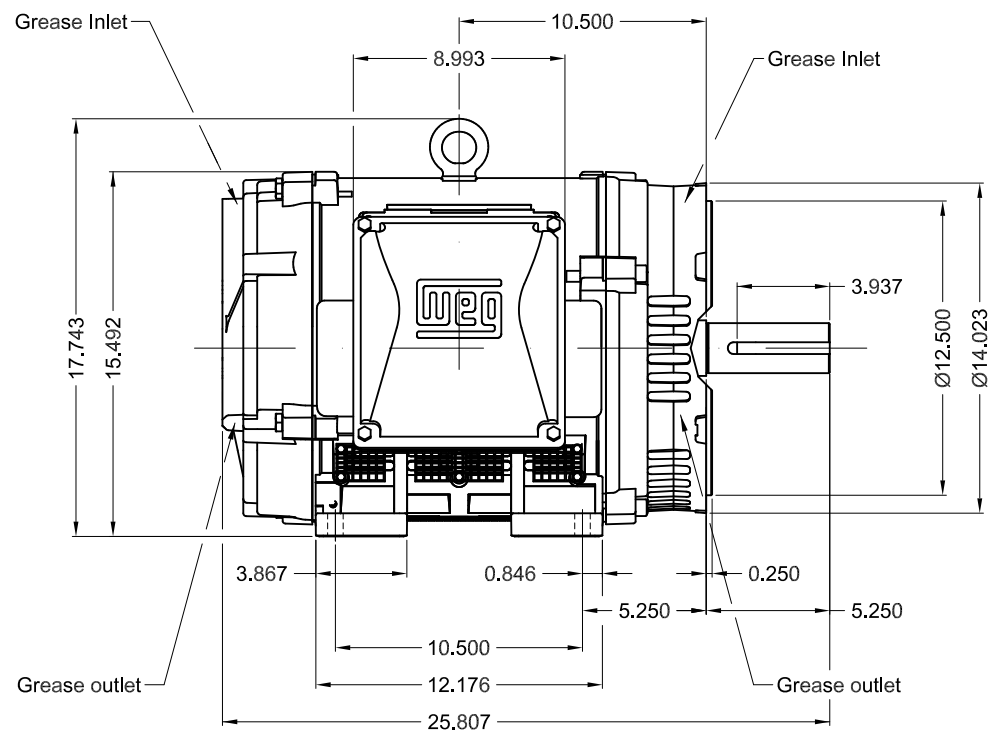
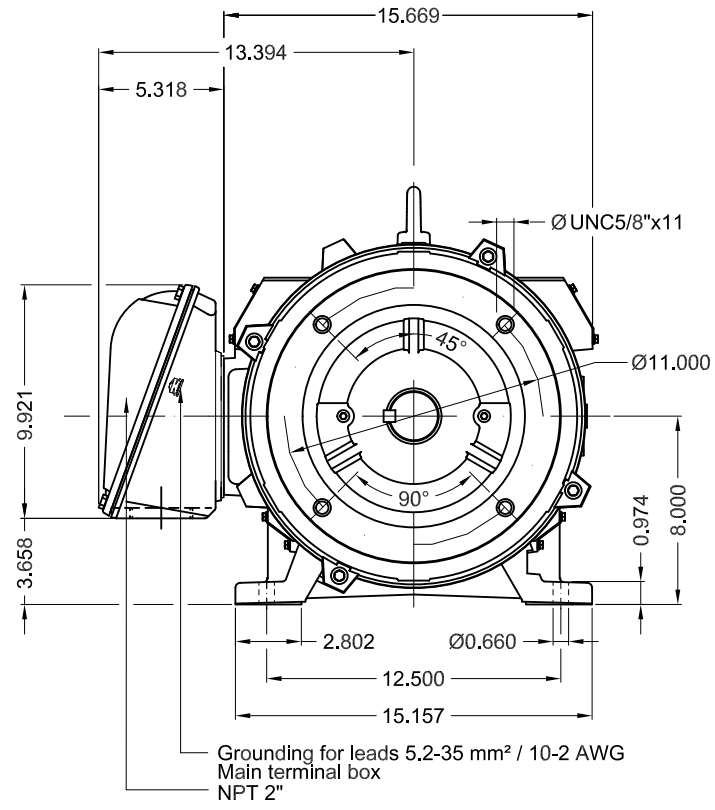

Color RAL 5009
Painting plan 203A
Mounting NEMA F-1
Mounting B34R(D)

40 HP 04 Poles 60 Hz A

1:8

ECM	LOC	SUMMARY OF MODIFICATIONS	HYBRISUSER	EXECUTED	CHECKED	RELEASED	DATE	VER
EXECUTED	HYBRISUSER	THREE PH. MOTOR W40 NEMA PREM. EFF.						00
CHECKED		FRAME 324TC IP23 ODP						
RELEASED								
REL. DATE		WMO Jaragua do Sul	Product Engineering					

PREVIEW
WDD 00
SHEET 1 / 1

