

LOAD PERFORMANCE CURVE

Three Phase Induction Motor - Squirrel Cage



Customer : _____

Product line : W40 NEMA Premium Efficiency Three-Phase Product code : 15728795

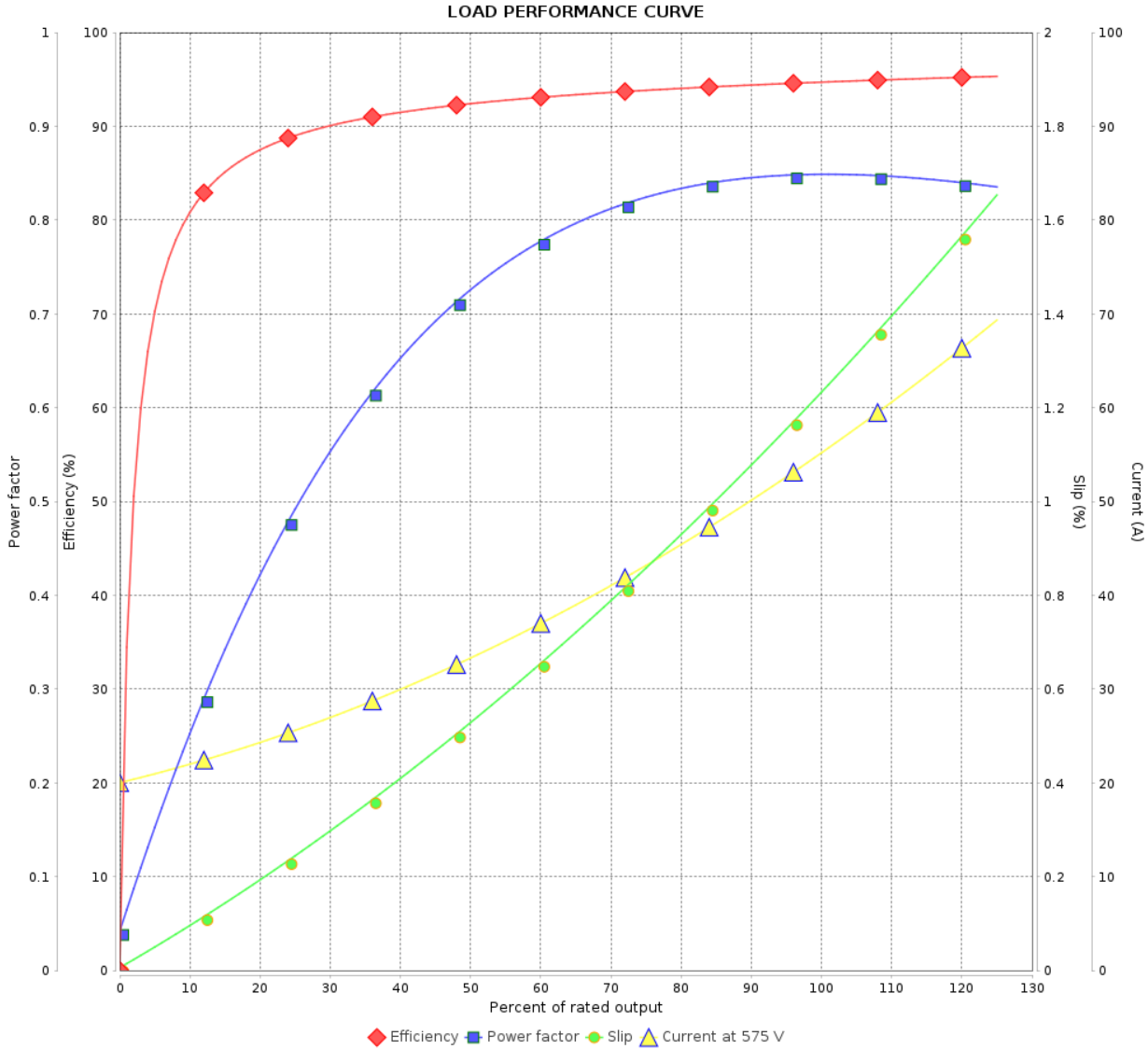

Performance : 575 V 60 Hz 6P

Rated current	: 56.2 A	Moment of inertia (J)	: 1.24 kgm ²
LRC	: 6.7	Duty cycle	: Cont.(S1)
Rated torque	: 36.7 kgfm	Insulation class	: F
Locked rotor torque	: 240 %	Service factor	: 1.15
Breakdown torque	: 250 %	Temperature rise	: 80 K
Rated speed	: 1185 rpm	Design	: B

Rev.	Changes Summary	Performed	Checked	Date
Performed by			Page 2 / 2	Revision
Checked by				
Date	30/10/2024			

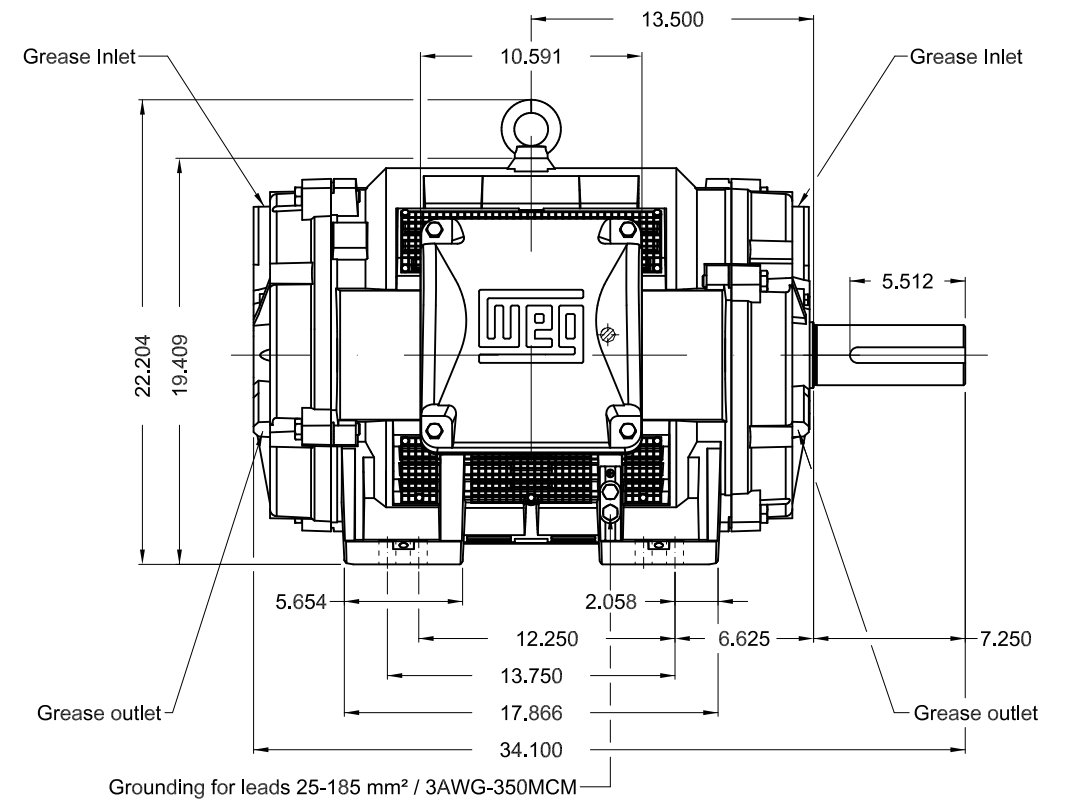
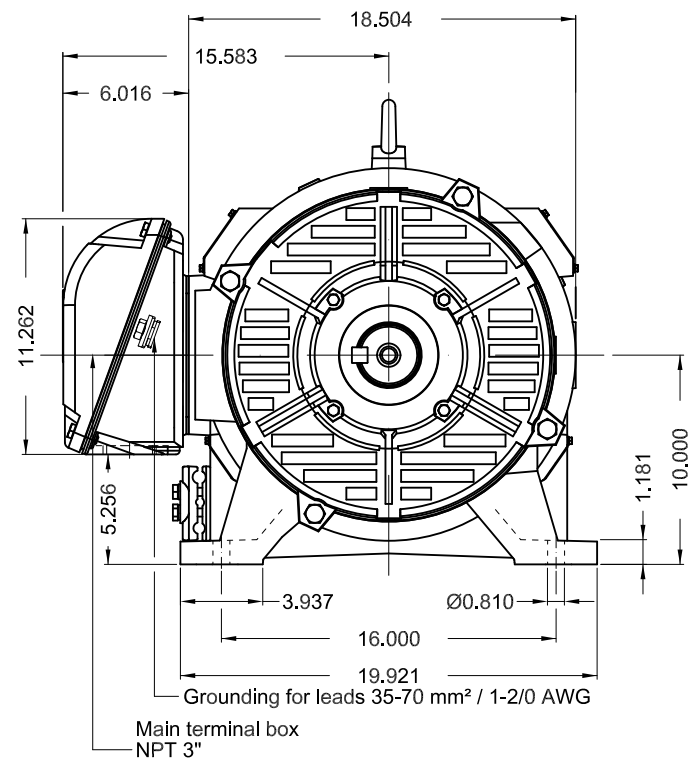

- DE roller bearing
- C3 NDE bearing
- Shaft locking device
- Shaft material - AISI/SAE 4140
- Color RAL 5009
- Painting plan 203A
- Mounting NEMA F-1
- Mounting B3R(D)

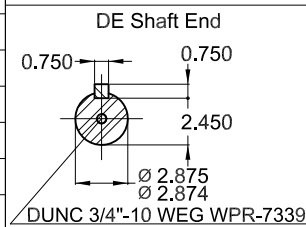

60 HP 06 Poles 60 Hz

A

1:9

ECM	LOC	SUMMARY OF MODIFICATIONS	HYBRISUSER	EXECUTED	CHECKED	RELEASED	DATE	VER
EXECUTED	HYBRISUSER	THREE PH. MOTOR W40 NEMA PREM. EFF.						00
CHECKED		FRAME 404/5T IP23 ODP						
RELEASED								
REL. DATE		WMO Jaragua do Sul	Product Engineering					

PREVIEW
WDD 00



SHEET 1 / 1