

DATA SHEET



Three Phase Induction Motor - Squirrel Cage

| | | | | | | | |
|--|---------------------------|--|------------------------|--|---------------------------|-----------------------------|------------------|
| Customer : | | | | | | | |
| Product line | | : W22 Brake Motor NEMA Premium Efficiency Three-Phase | | Product code : | | 15200457 | |
| Frame | : 324/6T | Locked rotor time | : 46s (cold) 26s (hot) | Output | : 25 HP (18.5 kW) | Temperature rise | : 80 K |
| Poles | : 6 | Duty cycle | : Cont.(S1) | Rated voltage | : 575 V | Ambient temperature | : -20°C to +40°C |
| Frequency | : 60 Hz | Altitude | : 1000 m.a.s.l. | Rated current | : 24.7 A | Protection degree | : IP55 |
| L. R. Amperes | : 153 A | Cooling method | : IC411 - TEFC | L. R. Amperes | : 153 A | Mounting | : F-1 |
| LRC | : 6.2x(Code G) | Rotation ¹ | : Both (CW and CCW) | LRC | : 6.2x(Code G) | Noise level ² | : 62.0 dB(A) |
| No load current | : 11.2 A | Starting method | : Direct On Line | No load current | : 11.2 A | Approx. weight ³ | : 294 kg |
| Rated speed | : 1180 rpm | | | Rated speed | : 1180 rpm | | |
| Slip | : 1.67 % | | | Slip | : 1.67 % | | |
| Rated torque | : 15.4 kgfm | | | Rated torque | : 15.4 kgfm | | |
| Locked rotor torque | : 210 % | | | Locked rotor torque | : 210 % | | |
| Breakdown torque | : 260 % | | | Breakdown torque | : 260 % | | |
| Insulation class | : F | | | Insulation class | : F | | |
| Service factor | : 1.25 | | | Service factor | : 1.25 | | |
| Moment of inertia (J) | : 0.4843 kgm ² | | | Moment of inertia (J) | : 0.4843 kgm ² | | |
| Design | : B | | | Design | : B | | |
| Output | 50% | 75% | 100% | Foundation loads | | | |
| Efficiency (%) | 92.4 | 93.0 | 93.0 | Max. traction | : 356 kgf | | |
| Power Factor | 0.65 | 0.76 | 0.81 | Max. compression | : 650 kgf | | |
| Losses at normative operating points (speed;torque), in percentage of rated output power | | | | | | | |
| P1 (0,9;1,0) | P2 (0,5;1,0) | P3 (0,25;1,0) | P4 (0,9;0,5) | P5 (0,5;0,5) | P6 (0,5;0,25) | P7 (0,25;0,25) | |
| 7.3 | 6.1 | 5.9 | 3.7 | 2.5 | 1.7 | 1.2 | |
| | | <u>Drive end</u> | | <u>Non drive end</u> | | | |
| Bearing type | : | 6312 C3 | | 6212 C3 | | | |
| Sealing | : | V'Ring | | Lip Seal | | | |
| Lubrication interval | : | 20000 h | | 20000 h | | | |
| Lubricant amount | : | 21 g | | 13 g | | | |
| Lubricant type | : | Mobil Polyrex EM | | | | | |
| Notes | | | | | | | |
| This revision replaces and cancel the previous one, which must be eliminated. (1) Looking the motor from the shaft end. (2) Measured at 1m and with tolerance of +3dB(A). (3) Approximate weight subject to changes after manufacturing process. (4) At 100% of full load. | | | | These are average values based on tests with sinusoidal power supply, subject to the tolerances stipulated in NEMA MG-1. | | | |
| Rev. | Changes Summary | | | Performed | Checked | Date | |
| Performed by | | | | | | | |
| Checked by | | | | | Page | Revision | |
| Date | 29/10/2024 | | | | 1 / 3 | | |

DATA SHEET

Three Phase Induction Motor - Squirrel Cage



Customer : _____

Brake information

Voltage: 525-575 V
Brake Torque: 40.8 kgfm

| Rev. | Changes Summary | Performed | Checked | Date |
|--------------|-----------------|-----------|---------|----------|
| Performed by | | | | |
| Checked by | | | Page | Revision |
| Date | 29/10/2024 | | 2 / 3 | |

LOAD PERFORMANCE CURVE

Three Phase Induction Motor - Squirrel Cage



Customer :

Product line : W22 Brake Motor NEMA Premium Efficiency Three-Phase Product code : 15200457

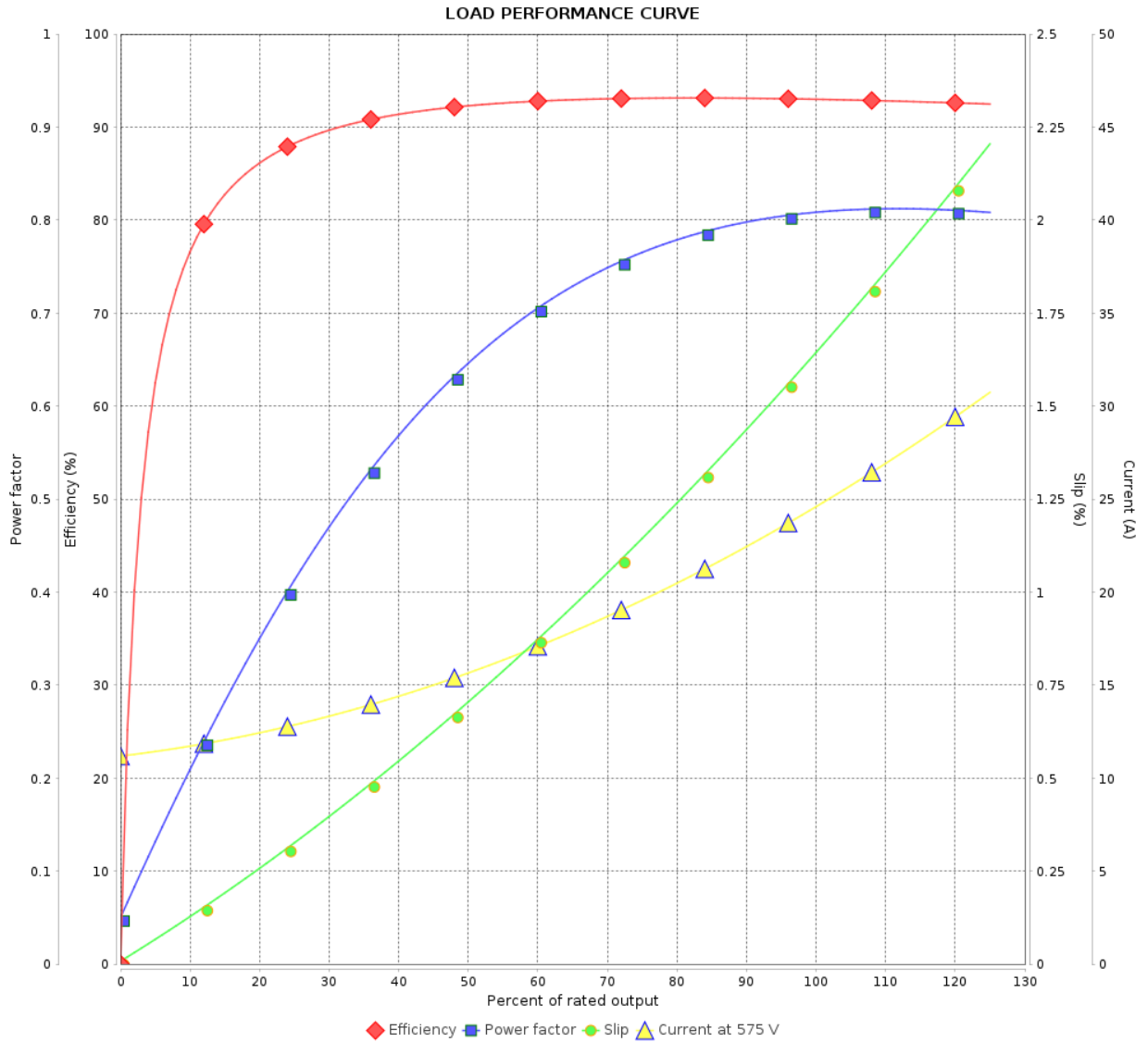

Performance : 575 V 60 Hz 6P

Rated current : 24.7 A
 LRC : 6.2
 Rated torque : 15.4 kgfm
 Locked rotor torque : 210 %
 Breakdown torque : 260 %
 Rated speed : 1180 rpm

Moment of inertia (J) : 0.4843 kgm²
 Duty cycle : Cont.(S1)
 Insulation class : F
 Service factor : 1.25
 Temperature rise : 80 K
 Design : B

| Rev. | Changes Summary | Performed | Checked | Date |
|--------------|-----------------|-----------|---------|----------|
| | | | | |
| Performed by | | | Page | Revision |
| Checked by | | | | |
| Date | | | | |

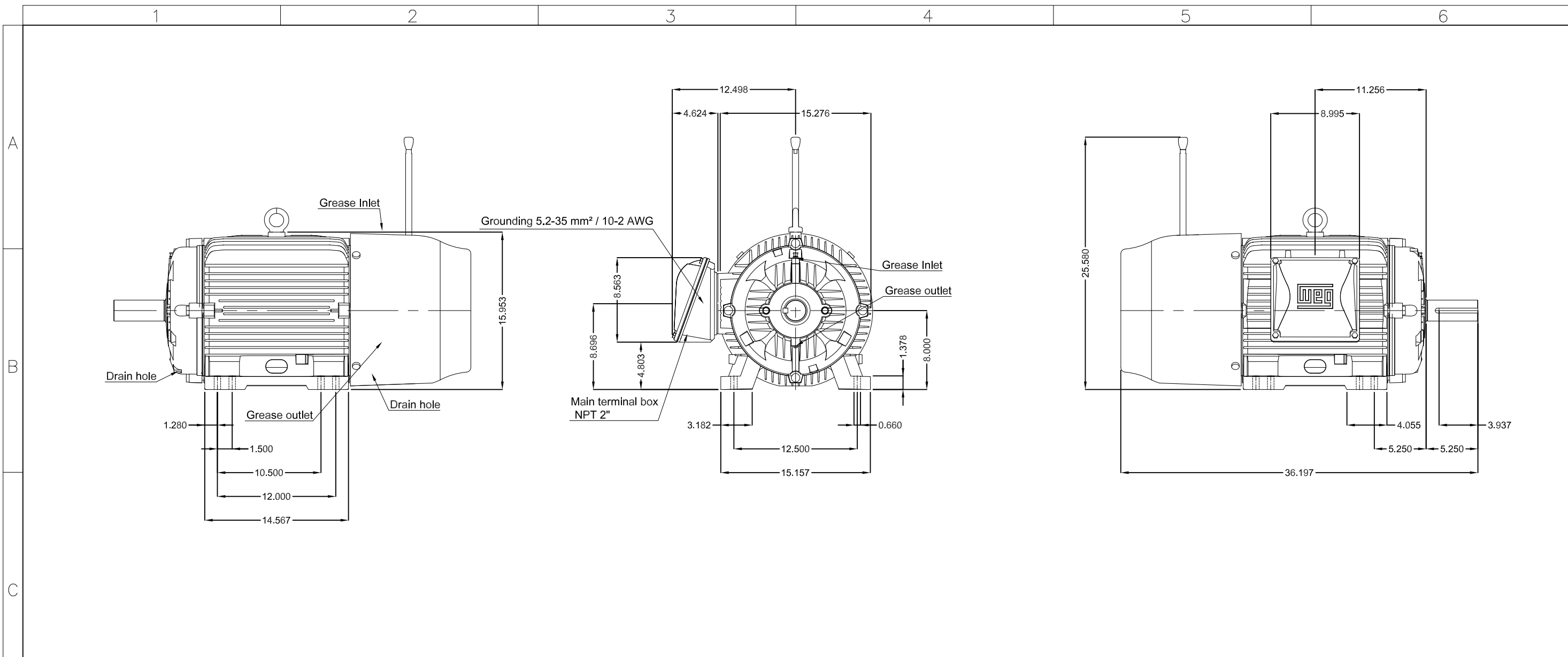

| | | | | | | | | | | |
|---|---|--|--|--|--|--|--|--|--|--|
| D | | | | | | | | | | |
| | 25 HP 06 Poles 60 Hz | | | | | | | | | |
| E | HYBRISUSER | | | | | | | | | |
| | ECM LOC SUMMARY OF MODIFICATIONS EXECUTED CHECKED RELEASED DATE VER | | | | | | | | | |
| | EXECUTED HYBRISUSER | | | | | | | | | |
| | CHECKED | | | | | | | | | |
| | RELEASED | | | | | | | | | |

| |
|-------------------------|
| Brake voltage 525-575 V |
| Break size 25 (400 Nm) |
| Color RAL 5009 |
| Painting plan 203A |
| Mounting NEMA F-1 |
| Mounting B3R(D) |

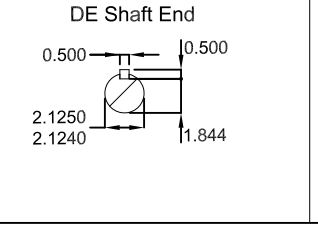

| | | | | | | | | | |
|--|--|--|--|--|--|--|--|--|--|
| | | | | | | | | | |
|--|--|--|--|--|--|--|--|--|--|

| | | | | | | | | | |
|--|--|--|--|--|--|--|--|--|--|
| | | | | | | | | | |
| | | | | | | | | | |
| | | | | | | | | | |
| | | | | | | | | | |
| | | | | | | | | | |

THREE PH. MOTOR W22 BRAKE MOTOR NEMA PREM. EFF. FRAME 324/6T IP55 TEFC

PREVIEW

WDD 00

SHEET /