

DATA SHEET



Three Phase Induction Motor - Squirrel Cage

Customer :						
Product line		: W21 In Line Extra Thrust NEMA Premium Efficiency Three-Phase		Product code : 15037011		
Frame	: 364/5LP		Locked rotor time	: 28s (cold) 16s (hot)		
Output	: 75 HP (55 kW)		Temperature rise	: 80 K		
Poles	: 4		Duty cycle	: Cont.(S1)		
Frequency	: 60 Hz		Ambient temperature	: -20°C to +40°C		
Rated voltage	: 575 V		Altitude	: 1000 m.a.s.l.		
Rated current	: 66.5 A		Protection degree	: IP55		
L. R. Amperes	: 466 A		Cooling method	: IC411 - TEFC		
LRC	: 7.0x(Code G)		Mounting	: W-6		
No load current	: 22.4 A		Rotation ¹	: Both (CW and CCW)		
Rated speed	: 1780 rpm		Noise level ²	: 75.0 dB(A)		
Slip	: 1.11 %		Starting method	: Direct On Line		
Rated torque	: 30.6 kgfm		Approx. weight ³	: 496 kg		
Locked rotor torque	: 240 %					
Breakdown torque	: 290 %					
Insulation class	: F					
Service factor	: 1.25					
Moment of inertia (J)	: 0.9798 kgm ²					
Design	: B					
Output	25%	50%	75%	100%	Foundation loads	
Efficiency (%)	0.000	94.5	95.0	95.4	Max. traction	
Power Factor	0.00	0.74	0.83	0.87	Max. compression	
			<u>Drive end</u>		<u>Non drive end</u>	
Bearing type	:	6314			7311BECB	
Sealing	:	Oil Seal			Lip Seal	
Lubrication interval	:	4895 h			4784 h	
Lubricant amount	:	27 g			18 g	
Lubricant type	:	Mobil Polyrex EM				
Notes						
This revision replaces and cancel the previous one, which must be eliminated. (1) Looking the motor from the shaft end. (2) Measured at 1m and with tolerance of +3dB(A). (3) Approximate weight subject to changes after manufacturing process. (4) At 100% of full load.			These are average values based on tests with sinusoidal power supply, subject to the tolerances stipulated in NEMA MG-1.			
Rev.	Changes Summary			Performed	Checked	Date
Performed by						
Checked by					Page	Revision
Date	29/10/2024				1 / 2	

LOAD PERFORMANCE CURVE

Three Phase Induction Motor - Squirrel Cage



Customer : _____

Product line : W21 In Line Extra Thrust NEMA Premium Efficiency Three-Phase Product code : 15037011

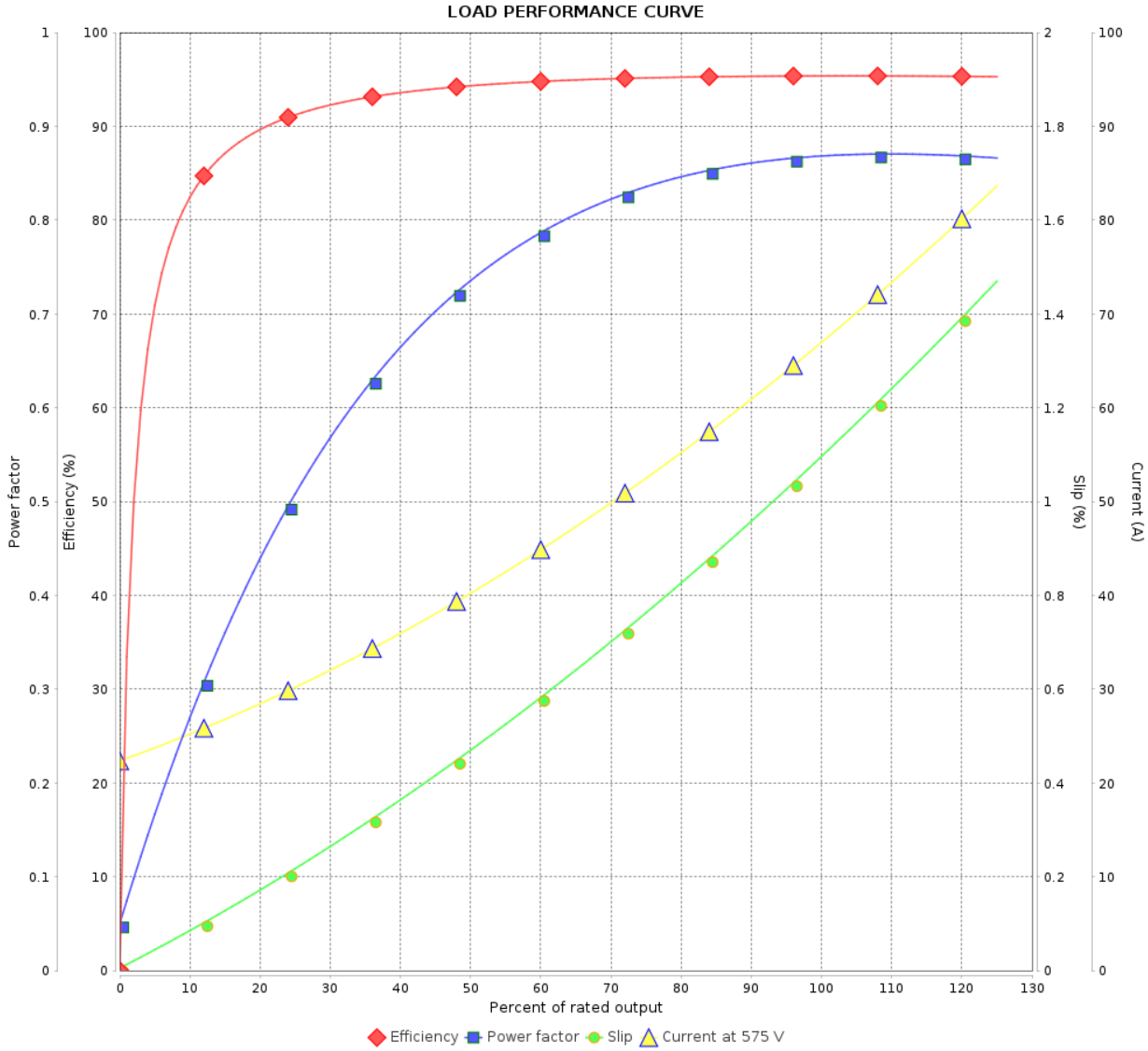

Performance : 575 V 60 Hz 4P

Rated current	: 66.5 A	Moment of inertia (J)	: 0.9798 kgm ²
LRC	: 7.0	Duty cycle	: Cont.(S1)
Rated torque	: 30.6 kgfm	Insulation class	: F
Locked rotor torque	: 240 %	Service factor	: 1.25
Breakdown torque	: 290 %	Temperature rise	: 80 K
Rated speed	: 1780 rpm	Design	: B

Rev.	Changes Summary	Performed	Checked	Date
Performed by			Page	Revision
Checked by				
Date				

ATENÇÃO/ATTENTION

MOTOR DEVE SER LIGADO APENAS NA POSIÇÃO VERTICAL
MOTOR MUST BE ENERGIZED ONLY IN THE VERTICAL POSITION

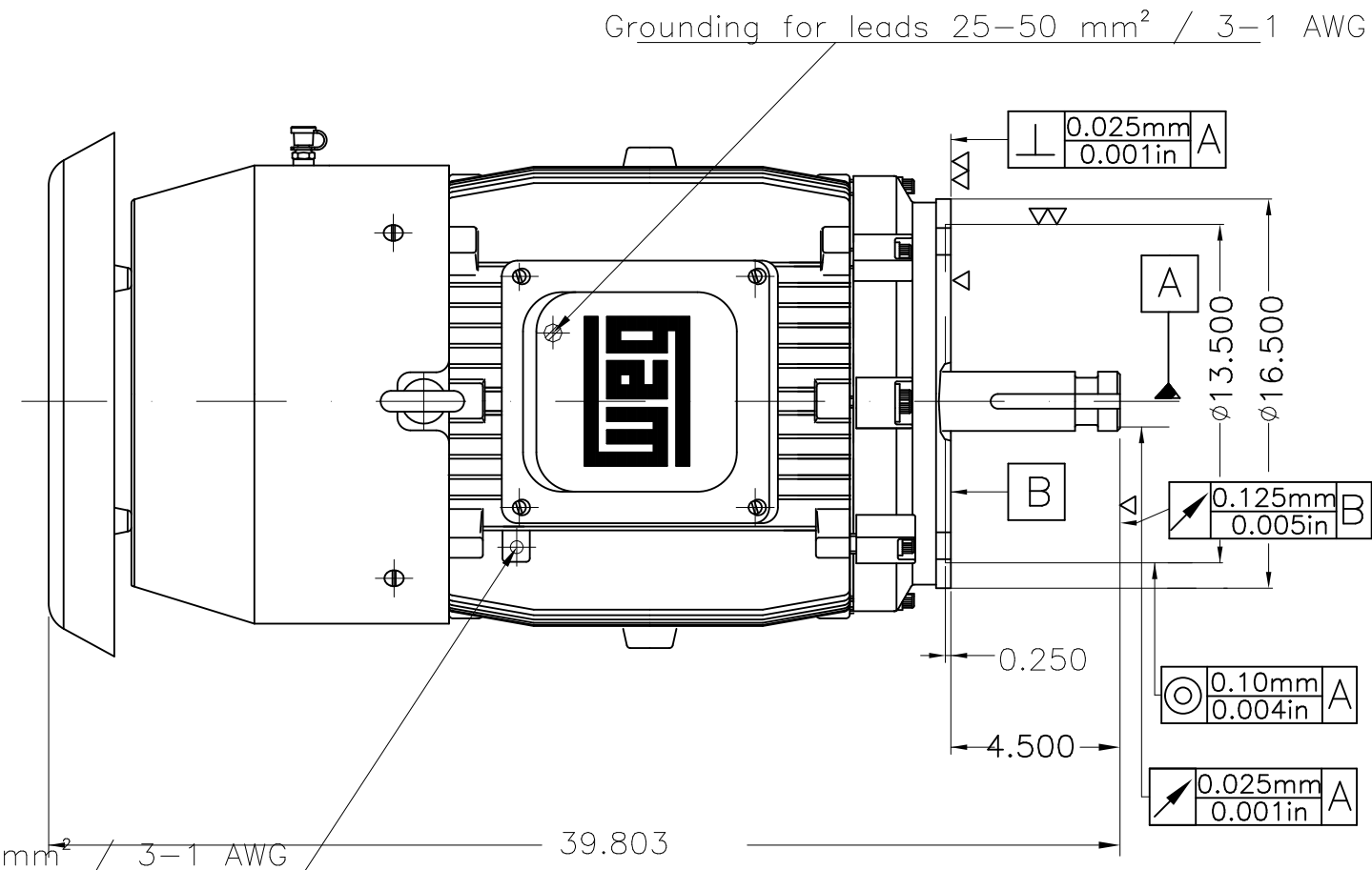
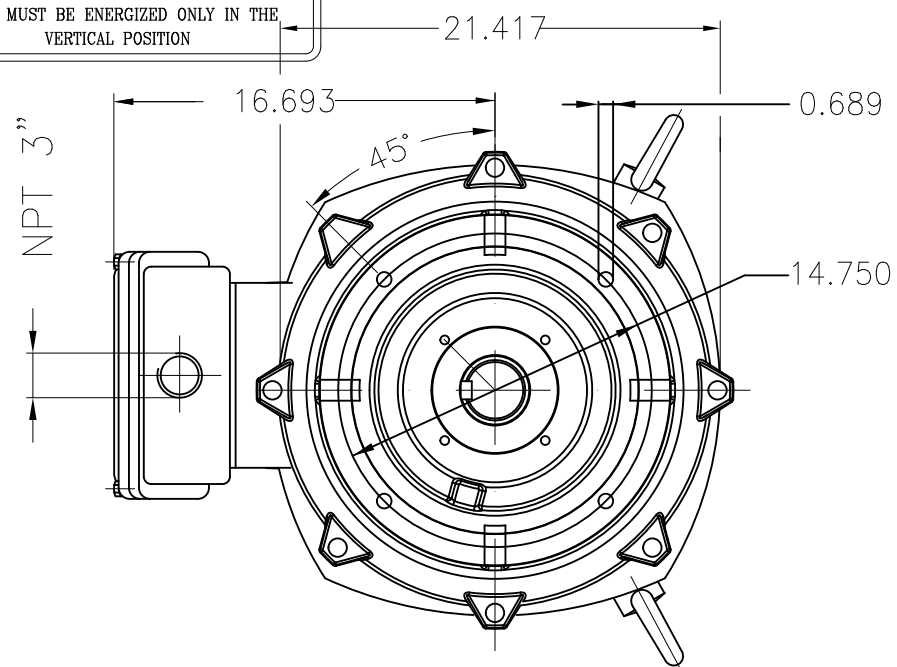

- Fan cover - steel plate
- Sealing - oil seal ring
- Rubber drain plug
- Without switch off thermal protection
- B key
- Grease - Mobil Polyrex EM
- Plastic flat plug
- Class F insulation - 80K temperature rise
- Without Space Heaters
- Shaft material - SAE/ABNT 1040/45
- Without terminal block
- NDE sealing - lip seal
- Aluminum fan
- Bearing cap
- Reduced balancing with half key
- Without epoxy in the cables outlet
- Certification CSA/UL
- Packing - crate
- Without thermal protection on bearings
- With grease fitting
- Color RAL 5009
- Painting plan 203A
- Service factor 1.25
- Mounting NEMA W-6
- Mounting V1

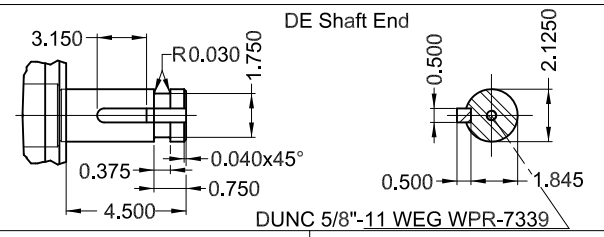

75 HP 04 Poles 60 Hz A

ECM		LOC	SUMMARY OF MODIFICATIONS		EXECUTED	CHECKED	RELEASED	DATE	VER
EXECUTED	HYBRISUSER		THREE PH. MOTOR IN LINE EXTRA THRUST NEMA PREM. EFF.						
CHECKED			FRAME 364/5LP IP55 TEFC						
RELEASED									
REL. DATE		WMO	Jaragua do Sul	Product Engineering					

PREVIEW
WDD 00
SHEET 1 / 1

Dimensions in inches XME A3