

# DATA SHEET



## Three Phase Induction Motor - Squirrel Cage

Customer :

Product line : W21 In Line Extra Thrust NEMA Premium Efficiency Three-Phase      Product code : 14922725

Frame	: 326LP	Locked rotor time	: 59s (cold) 33s (hot)
Output	: 50 HP (37 kW)	Temperature rise	: 80 K
Poles	: 2	Duty cycle	: Cont.(S1)
Frequency	: 60 Hz	Ambient temperature	: -20°C to +40°C
Rated voltage	: 208-230/460 V	Altitude	: 1000 m.a.s.l.
Rated current	: 124-112/56.1 A	Protection degree	: IP55
L. R. Amperes	: 893-806/404 A	Cooling method	: IC411 - TEFC
LRC	: 7.2x(Code H)	Mounting	: W-6
No load current	: 24.7-28.2/14.1 A	Rotation <sup>1</sup>	: Both (CW and CCW)
Rated speed	: 3560 rpm	Noise level <sup>2</sup>	: 81.0 dB(A)
Slip	: 1.11 %	Starting method	: Direct On Line
Rated torque	: 10.2 kgfm	Approx. weight <sup>3</sup>	: 330 kg
Locked rotor torque	: 280 %		
Breakdown torque	: 260 %		
Insulation class	: F		
Service factor	: 1.15		
Moment of inertia (J)	: 0.2284 kgm <sup>2</sup>		
Design	: B		

Output	25%	50%	75%	100%	Foundation loads
Efficiency (%)	0.000	92.4	93.6	94.1	Max. traction
Power Factor	0.00	0.81	0.87	0.88	Max. compression

	<u>Drive end</u>	<u>Non drive end</u>
Bearing type	: 6212 C3	7310BECB
Sealing	: Oil Seal	Lip Seal
Lubrication interval	: 6072 h	4017 h
Lubricant amount	: 13 g	15 g
Lubricant type	: Mobil Polyrex EM	

### Notes

This revision replaces and cancel the previous one, which must be eliminated.

- (1) Looking the motor from the shaft end.
- (2) Measured at 1m and with tolerance of +3dB(A).
- (3) Approximate weight subject to changes after manufacturing process.
- (4) At 100% of full load.

These are average values based on tests with sinusoidal power supply, subject to the tolerances stipulated in NEMA MG-1.

Rev.	Changes Summary	Performed	Checked	Date
Performed by				
Checked by			Page	Revision
Date	29/10/2024		1 / 2	

# LOAD PERFORMANCE CURVE

Three Phase Induction Motor - Squirrel Cage



Customer :

Product line : W21 In Line Extra Thrust NEMA Premium Efficiency Three-Phase

Product code : 14922725

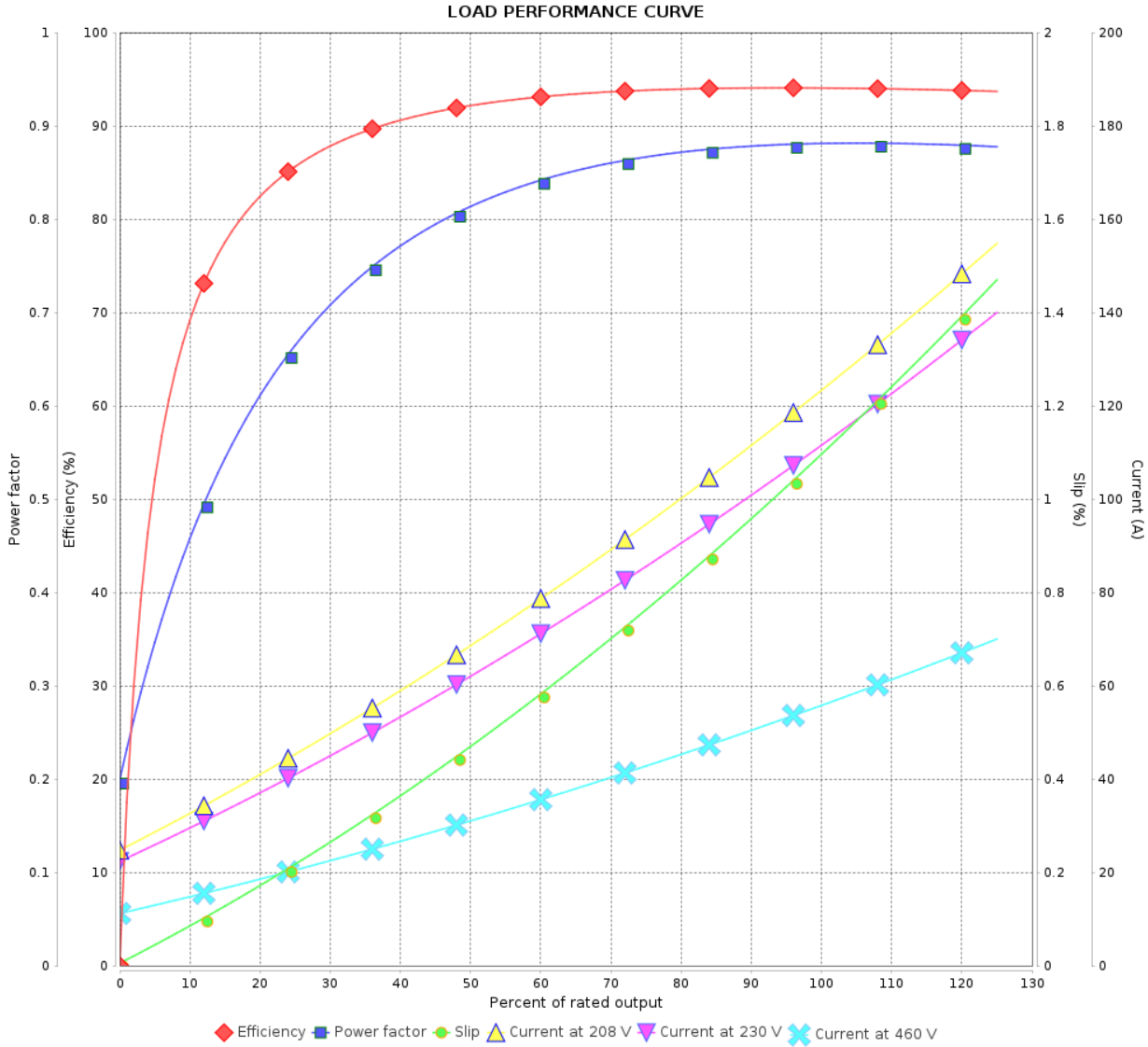

Performance : 208-230/460 V 60 Hz 2P

Rated current : 124-112/56.1 A  
 LRC : 7.2  
 Rated torque : 10.2 kgfm  
 Locked rotor torque : 280 %  
 Breakdown torque : 260 %  
 Rated speed : 3560 rpm

Moment of inertia (J) : 0.2284 kgm<sup>2</sup>  
 Duty cycle : Cont.(S1)  
 Insulation class : F  
 Service factor : 1.15  
 Temperature rise : 80 K  
 Design : B

Rev.	Changes Summary	Performed	Checked	Date
Performed by			Page 2 / 2	Revision
Checked by				
Date	29/10/2024			

EIXO/SHAFT	
PADRÃO/STANDARD	X
OPCIONAL/OPTIONAL	
ESPECIAL/SPECIAL	

Dimensões em polegada  
Dimensions in inches

**CERTIFIED WEG MOTORES**  
Certified document.  
Not subject to changes.

THIS IS AN UPDATED REVISION, THE PREVIOUS ONE MUST BE DISREGARDED.

**ATENÇÃO/ATTENTION**  
MOTOR DEVE SER LIGADO APENAS NA POSIÇÃO VERTICAL  
MOTOR MUST BE ENERGIZED ONLY IN THE VERTICAL POSITION

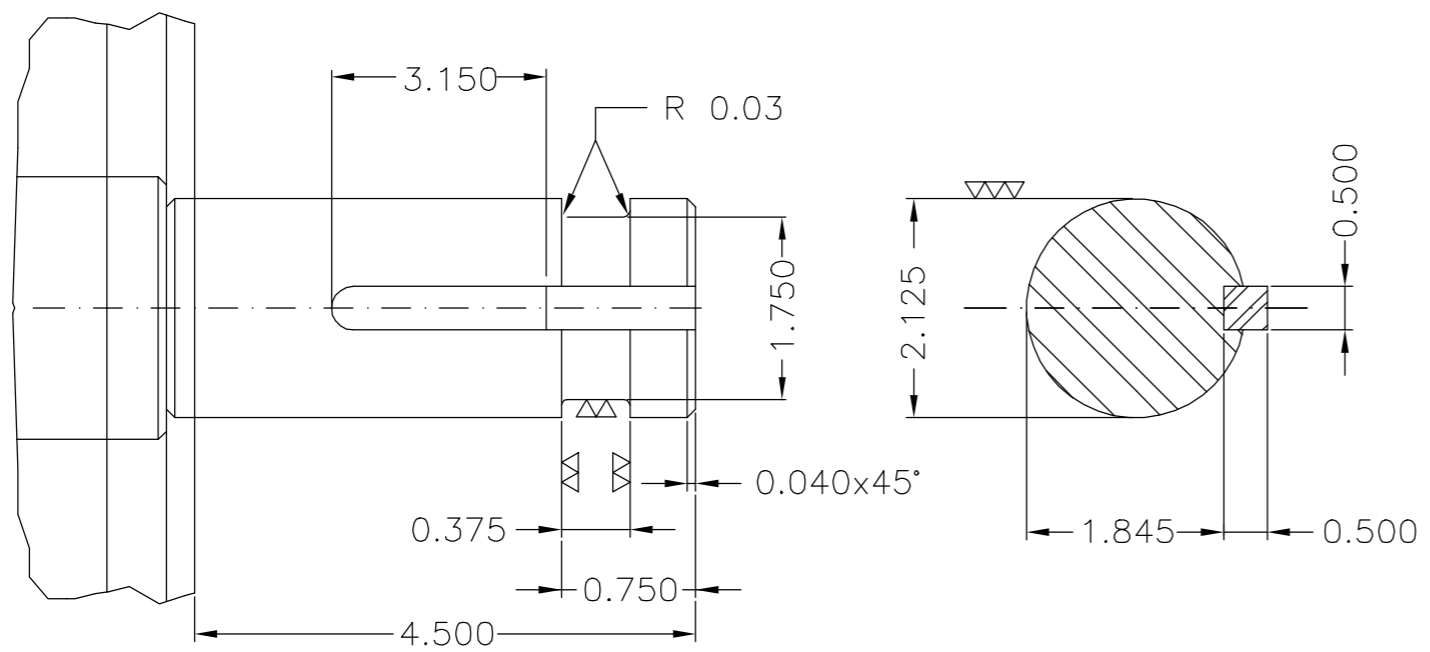
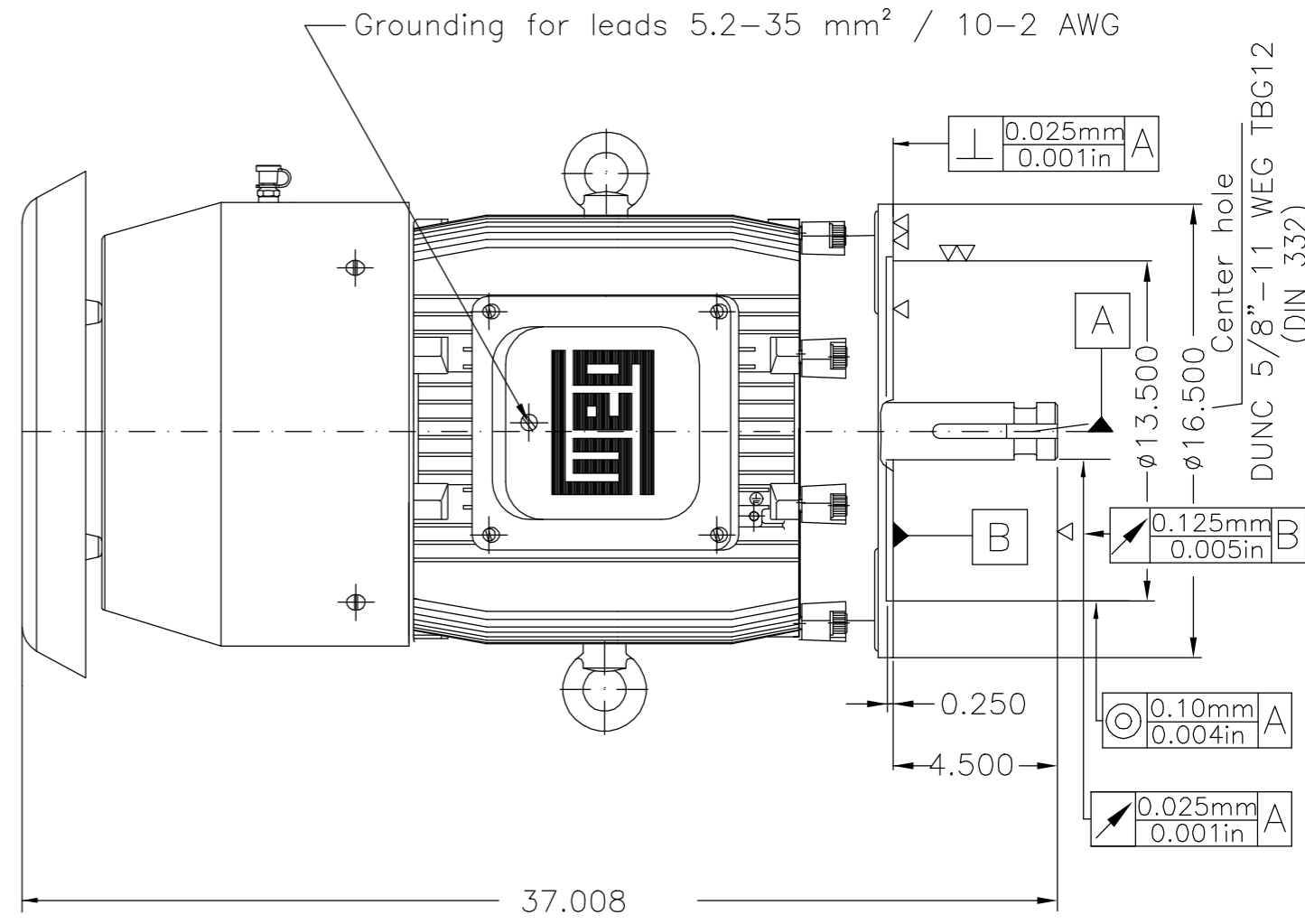
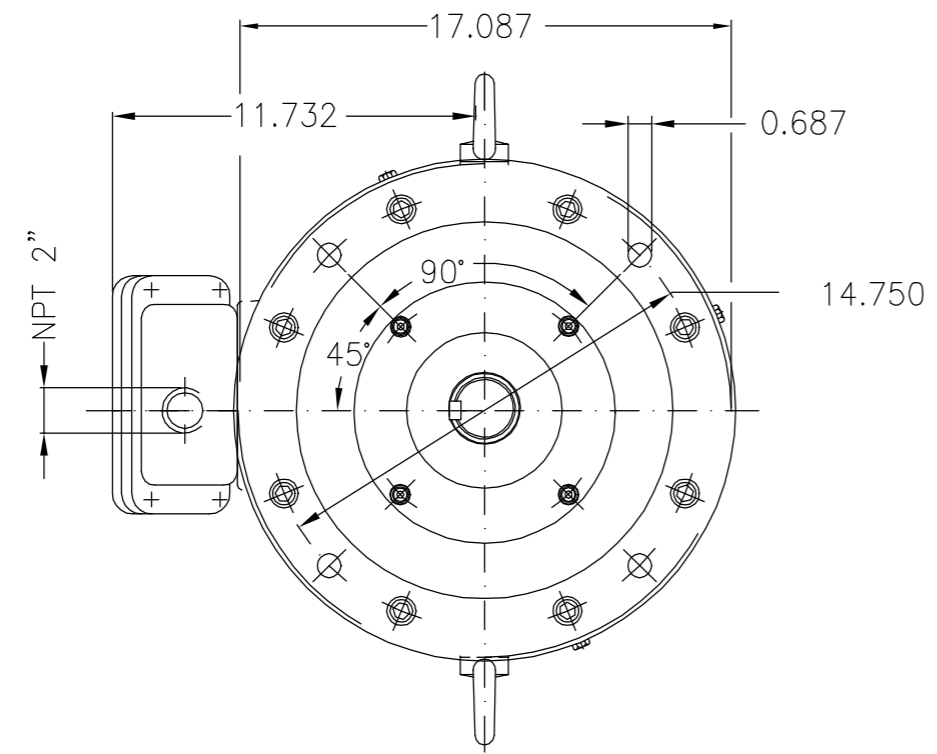

Cor RAL 5009 / Color RAL 5009  
Plano de pintura 203A / Painting plan 203A  
Forma construtiva NEMA W-6 / Mounting NEMA W-6  
Forma construtiva V1 / Mounting V1  
**V.J. PAMENSKY CANADA INC.**

500002148791	ALT CONFORME 418229042	CLAUDEMIRR	JACKSONDC	JACKSONDC	14.06.2022	02			
500001664158	ALT. CONFORME CLAIM 415778009	FRANCINES	RICLAV	RICLAV	08.10.2019	01			
ECM	LOC	SUMMARY OF MODIFICATIONS			EXECUTED	CHECKED	RELEASED	DATE	VER
EXECUTED	DANIELAW		THREE-PHASE IN LINE EXTRA THRUST MOTOR			10006642905			
CHECKED	CLEITONGS		FRAME 326LP IP55 TEFC			000   02			
RELEASED	CLEITONGS								
REL DT	23.05.2019	WMO	Jaragua do Sul	Product Engineering	SHEET	1 / 1			

50 HP	04 Poles	60Hz		B
50 HP	02 Poles	60Hz	415472505/0	A

UNCONTROLLED COPY RELEASED ZME A3