

DATA SHEET

Three Phase Induction Motor - Squirrel Cage



Customer :

Product line : W22 Tru-Metric IE3 Three-Phase Product code : 15058465

Frame	: L80	Locked rotor time	: 23s (cold) 13s (hot)
Output	: 1 HP (0.75 kW)	Temperature rise	: 80 K
Poles	: 4	Duty cycle	: S1
Frequency	: 60 Hz	Ambient temperature	: -20°C to +40°C
Rated voltage	: 208-230/460 V	Altitude	: 1000 m.a.s.l.
Rated current	: 3.20-2.90/1.45 A	Protection degree	: IP55
L. R. Amperes	: 25.9-23.5/11.7 A	Cooling method	: IC411 - TEFC
LRC	: 8.1	Mounting	: B35L(E)
No load current	: 2.08-1.88/0.940 A	Rotation ¹	: Both (CW and CCW)
Rated speed	: 1736 rpm	Noise level ²	: 48.0 dB(A)
Slip	: 3.56 %	Starting method	: Direct On Line
Rated torque	: 0.418 kgfm	Approx. weight ³	: 19.0 kg
Locked rotor torque	: 350 %		
Breakdown torque	: 360 %		
Insulation class	: F		
Service factor	: 1.25		
Moment of inertia (J)	: 0.0037 kgm ²		
Design	: N		

Output	25%	50%	75%	100%	Foundation loads	
Efficiency (%)	71.3	80.0	83.0	85.5	Max. traction	: 38 kgf
Power Factor	0.36	0.53	0.67	0.76	Max. compression	: 57 kgf

Losses at normative operating points (speed;torque), in percentage of rated output power

P1 (0,9;1,0)	P2 (0,5;1,0)	P3 (0,25;1,0)	P4 (0,9;0,5)	P5 (0,5;0,5)	P6 (0,5;0,25)	P7 (0,25;0,25)
15.9	12.9	13.1	10.0	6.8	5.5	3.9

	Drive end	Non drive end
Bearing type	: 6204 ZZ	6203 ZZ
Sealing	: V'Ring	V'Ring
Lubrication interval	: 0 h	0 h
Lubricant amount	: 0 g	0 g
Lubricant type	Mobil Polyrex EM	

Notes

This revision replaces and cancel the previous one, which must be eliminated.

- (1) Looking the motor from the shaft end.
- (2) Measured at 1m and with tolerance of +3dB(A).
- (3) Approximate weight subject to changes after manufacturing process.
- (4) At 100% of full load.

These are average values based on tests with sinusoidal power supply, subject to the tolerances stipulated in NEMA MG-1.

Rev.	Changes Summary	Performed	Checked	Date
Performed by				
Checked by				
Date	29/10/2024			
			Page	Revision
			1 / 2	

LOAD PERFORMANCE CURVE

Three Phase Induction Motor - Squirrel Cage



Customer :

Product line : W22 Tru-Metric IE3 Three-Phase Product code : 15058465

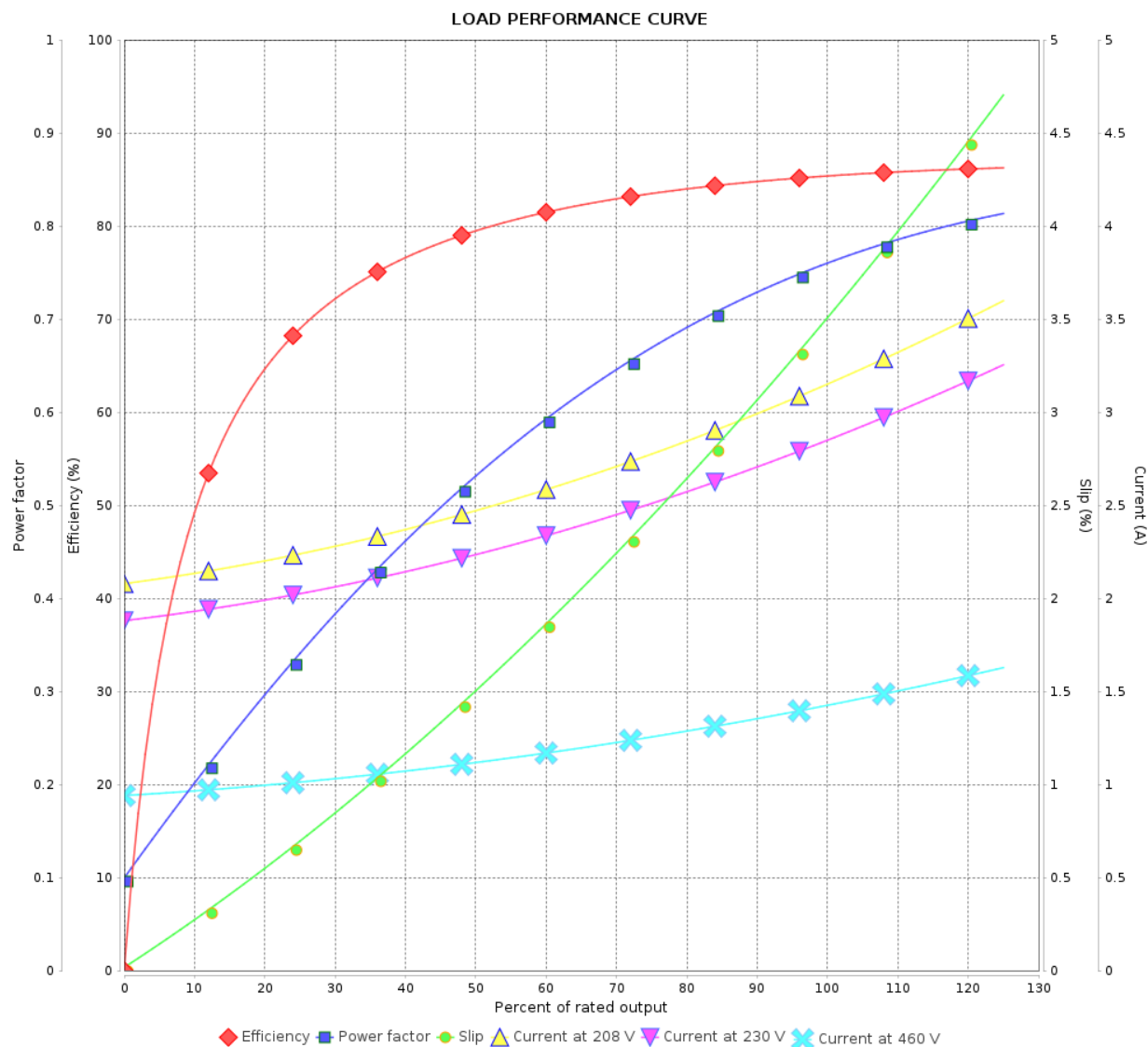

Performance : 208-230/460 V 60 Hz 4P

Rated current : 3.20-2.90/1.45 A
LRC : 8.1
Rated torque : 0.418 kgfm
Locked rotor torque : 350 %
Breakdown torque : 360 %
Rated speed : 1736 rpm

Moment of inertia (J) : 0.0037 kgm²
Duty cycle : S1
Insulation class : F
Service factor : 1.25
Temperature rise : 80 K
Design : N

Rev.	Changes Summary		Performed	Checked	Date
Performed by				Page 2 / 2	Revision
Checked by					
Date	29/10/2024				

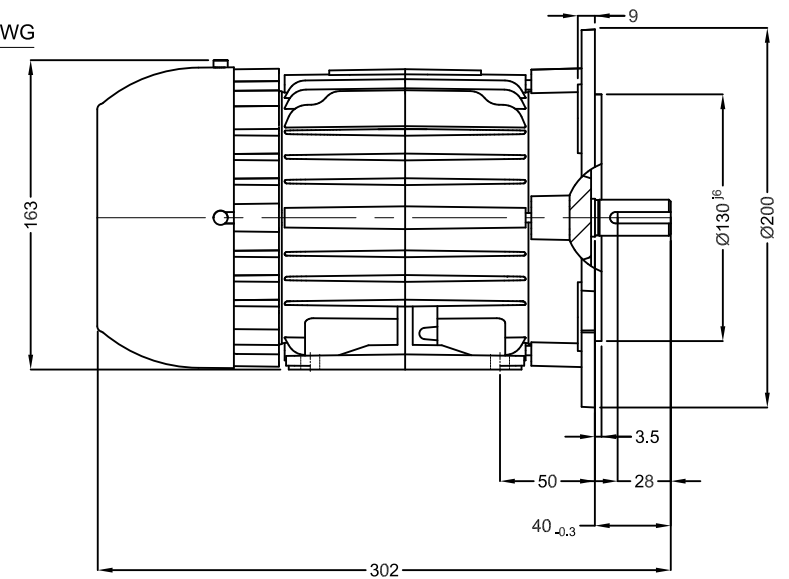

Color RAL 5009
Painting plan 207A
Mounting B35L(E)

